



## HOSPITALITY PLASTIC SEATS

### MODEL 2155CTJ

- ELONGATED SEAT, OPEN FRONT LESS COVER
- HEAVY DUTY SOLID PLASTIC
- DURAGUARD® ANTIMICROBIAL AGENT
- JUST•LIFT®, INTEGRATED HINGE SYSTEM
- STA-TITE®, COMMERCIAL FASTENING SYSTEM™

**DuraGuard®**  
ANTIMICROBIAL

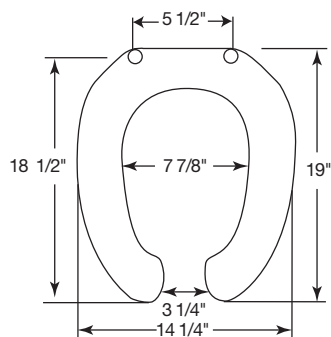

Ring thickness is 13/16"  
Ring thickness including the bumper is 1"  
Height of the seat is 2-1/4"

Seats shall be 2155CTJ as manufactured by Church Seats. Seats shall contain DuraGuard®, an antimicrobial agent. Seats shall be heavy weight and injection molded of solid plastic. Seats shall be open front less cover for elongated bowl and feature large molded-in bumpers. Seats shall have STA-TITE®, Commercial Fastening System™, featuring external check hinges with 300 Series stainless posts and pintles that stop seat 11 degrees beyond vertical. Seats shall feature the JUST•LIFT® integrated hinge system for enhanced cleanability and hygiene. Color to be White.



**STA-TITE®, COMMERCIAL FASTENING SYSTEM™, ONE-PIECE INTEGRATED NUT AND WASHER**



**JUST•LIFT® PROVIDES 1-1/2" OF LIFT HEIGHT FOR ENHANCED CLEANABILITY**



**CONTOURED SEAT**

**JUST•LIFT®**  
with **STATITE®**  
Commercial Fastening System™

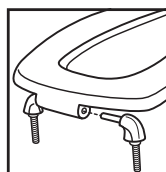

Assemble hinges.

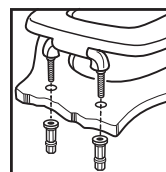

Finger-tighten fastening nuts.

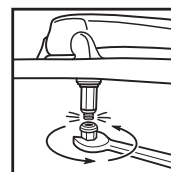

Using wrench, tighten until lower portion shears off.