

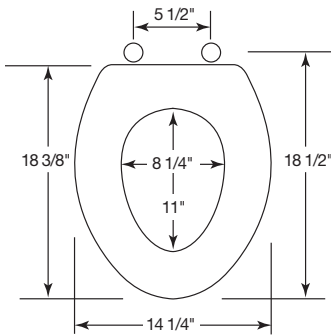

HOSPITALITY PLASTIC SEATS

MODEL 7600TJ

- ELONGATED SEAT, CLOSED FRONT WITH COVER
- HEAVY DUTY PLASTIC SEAT
- 300 SERIES STAINLESS STEEL HINGE AND BOLT
- JUST•LIFT®, INTEGRATED HINGE SYSTEM
- STA-TITE®, COMMERCIAL FASTENING SYSTEM™



Ring thickness is 5/8"
 Ring thickness including the bumper is 1"
 Height of the seat with cover is 1-7/8"

Seats shall be 7600TJ as manufactured by Church Seats. Seats shall be commercial weight and injection molded of solid plastic. Seat shall be closed front with cover for elongated bowl and feature molded in bumpers. Seats shall have STA-TITE®, Commercial Fastening System™, featuring 300 Series stainless steel posts and pintles. Seats shall feature JUST•LIFT® integrated hinge system for enhanced cleanability and hygiene. Color to be white.



STA-TITE®, COMMERCIAL FASTENING SYSTEM™, ONE-PIECE INTEGRATED NUT AND WASHER



JUST•LIFT® PROVIDES 1-1/2" OF LIFT HEIGHT FOR ENHANCED CLEANABILITY

JUST•LIFT® with STA-TITE® Commercial Fastening System™

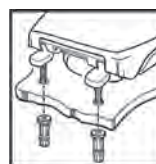

Finger-tighten fastening nuts.

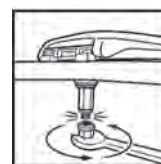

Using wrench, tighten until lower portion shears off.