

# Single-Flush Actuators for Geberit Sigma Concealed Tanks, 2x6 Installations

## Product Specifications

Actuators for concealed tank and carrier system. Actuator flush plates and push buttons shall be zinc die-cast, molded plastic or fabricated stainless steel and plated to guard against scratches. All components shall be compliant with applicable codes and product standards.

## Dimensions

Single-Flush Actuator Plates and Cover Plates (Fig. 1)

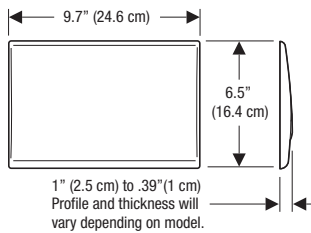

Round Single-Flush Push Button (Fig. 2)

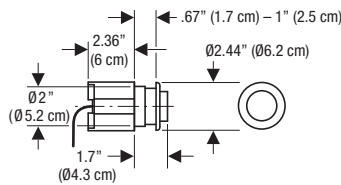

Square Single-Flush Push Button (Fig. 3)

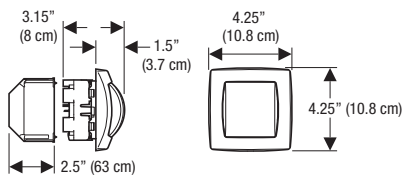

## Finishes

### Single-Flush Actuators

Style	Material	Finish	Model No.
Sigma10	Plastic	White-Polish-White*	115.758.KJ.1
		White-Gold-White*	115.758.KK.1
		White-Matte-Matte*	115.758.KL.1
		Black-Polish-Black*	115.758.KM.1
		Polish-Matte-Polish*	115.758.KH.1
		Matte-Polish-Matte*	115.758.KN.1
Tango	Zinc die cast	Alpine White	115.760.11.1
		Polished Chrome	115.760.21.1
		Matte Chrome	115.760.46.1
		Pergamon	115.760.EP.1
		Satinox	115.760.GM.1
		Matte Palladium	115.760.HC.1
		Oil Rubbed Bronze	115.760.HM.1
		ForeverShine™	115.760.IB.1
		PVD Polished Nickel	
		ForeverShine™	115.760.ID.1
		PVD Brushed Nickel	
		Polish-Matte**	115.760.KA.1
Mambo	Stainless Steel	Brushed SS	115.751.00.1

Rumba	Plastic	Alpine White	115.750.11.1
		Polished Chrome	115.750.21.1
		Matte Chrome	115.750.46.1
		Pergamon	115.750.EP.1
		Satinox	115.750.GM.1

### Hands Free Actuators

Mambo	Stainless Steel	Brushed SS <b>NEW</b> (AC Power) <sup>††</sup>	115.890.00.1
		Brushed SS (Battery/DC Power)	115.891.00.1

Refer to individual product sheet for Hands Free technical information

### Cover Plates

Round	Zinc Die-Cast	Alpine White	115.765.11.1
		Matte Chrome	115.765.46.1
	Stainless Steel	Brushed SS	115.798.00.1

### Single-Flush Push Buttons

Round	Plastic	Alpine White	115.114.11.1
		Polished Chrome	115.114.21.1
	Stainless Steel	Brushed SS	115.114.FW.1
Square	Plastic	Alpine White	115.941.11.1
		Polish-Matte**	115.941.KA.1

\*\* Finishes follow this pattern = Frame-Button  
Polish = Polished Chrome  
Matte = Matte Chrome

†† Requires 230 V, 50 Hz or transformer to 120 V, 60 Hz.  
Suggested accessory 115.861.00.1.

## Warranty

One-year warranty on actuator flush plates. ForeverShine™ finishes installed in residential-use applications are warranted not to corrode, tarnish or discolor for the life of the Product.

## Features

- Designed to maintain appearance push after push
- Moving parts are accessible behind actuator flush panel
- Made of molded plastic, zinc die cast or stainless steel and plated
- Available in 18 designer finishes
- Initiates flush of 1.6 GPF (6 LPF)



### ARCHITECT/ENGINEER APPROVAL

Job Name \_\_\_\_\_

Date \_\_\_\_\_ Quantity \_\_\_\_\_

Model Specified \_\_\_\_\_

Variations Specified \_\_\_\_\_

Customer/Wholesaler \_\_\_\_\_

Contractor \_\_\_\_\_

Architect \_\_\_\_\_

# Single-Flush Hands Free Actuator for Toilets with Sigma Concealed Tank, 2x6 Installations

**Application**

- For automatic "hands free" sensing and flush actuation, in hygienic or ADA compliant applications
- For public or residential spaces
- For new installations or retrofit to existing Geberit 111.335 frame installs
- For low consumption toilet single flushing volumes of 1.6 GPF (6 LPF)

**Product Specifications**

- Stainless steel – Brushed stainless steel
- Detection distance: up to 24 in (60 cm)
- Automatic hygiene flush: 24 h after last flush cycle
- Battery type Alkaline 1.5 V (LR20 "D" cell)\*
- Operating voltage: 3 V DC
- User detection time: 7 s
- Manual actuation force < 4.5 lbf (20 N)

**Scope of Supply**

- Cover plate with infrared window (replaceable)
- Infrared control, premounted on fixation frame
- Servo motor, premounted to lifter mechanism
- Fastening material
- Battery box and 2x "D" alkaline batteries\*
- 120 V 60 Hz or 230 V 50 Hz transformer not included. Recommend accessory 115.861.00.1.\*\*

**Features**

- Proven infrared triangulation detection method with background fade-out and auto-calibration to environment
- Low noise servo motor actuates existing gravity flush valve. Motor auto-calibrates to adjust for installation tolerances.
- Includes manual override button
- "Low battery" warning (2-stage: flashing LED when battery starts to go low; continuous red light when cannot flush)\*
- Dynamic flushing time reduction during periods of high traffic to reduce water consumption
- Designed to maintain appearance push after push
- Vandal resistant stainless steel cover plate and independent sensor electronics to prevent tampering
- Pre-installed electrical connectors with cross-polarity protection (one-way connection)
- Tool-free maintenance, with access to battery box, flush and fill valve behind the actuator plate
- Battery change can be performed without turning off water\*

**Warranty**

Electronic components: 2 years from installation  
 Actuator flush plate finish: 5 years (residential);  
 1 year: public

\* Battery version only.  
 \*\*AC version only.

**Dimensions**

**Single-Flush Actuator Plates**

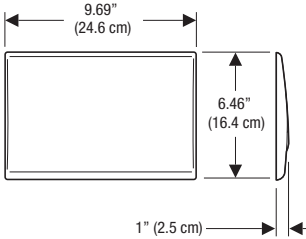

**Finishes**

**Hands Free Actuators**

Style	Material	Finish	Model No.
Mambo	Stainless Steel	Brushed SS (AC Power) <b>NEW</b>	115.890.00.1
		Brushed SS (Battery/DC Power)	115.891.00.1

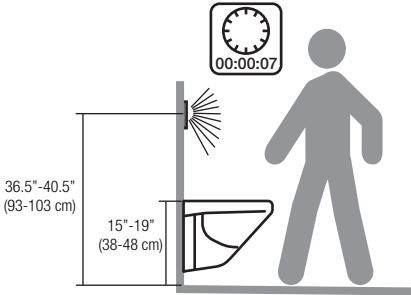

Installing highly reflective surfaces (such as mirrors) in the immediate vicinity of the water closet flush control should be avoided, as these can lead to incorrect releases and malfunctions.

Geberit product is ADA compliant when fixture and actuator are installed at proper heights.



**ARCHITECT/ENGINEER APPROVAL**

Job Name \_\_\_\_\_

\_\_\_\_\_

Date \_\_\_\_\_ Quantity \_\_\_\_\_

Model Specified \_\_\_\_\_

Variations Specified \_\_\_\_\_

\_\_\_\_\_

Customer/Wholesaler \_\_\_\_\_

\_\_\_\_\_

Contractor \_\_\_\_\_

\_\_\_\_\_

Architect \_\_\_\_\_

\_\_\_\_\_

# Single-Flush Actuators for Geberit Sigma Concealed Tanks, 2x4 Installations

## Product Specifications

Actuators for concealed tank and carrier system. Actuator flush plates and push buttons shall be zinc die-cast, molded plastic or fabricated stainless steel and plated to guard against scratches. All components shall be compliant with applicable codes and product standards.

## Dimensions

Single-Flush Actuator Plates and Cover Plates (Fig. 1)

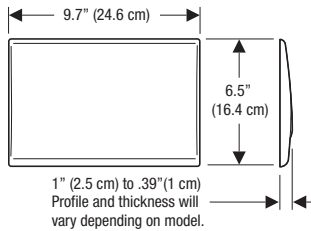

Square Single-Flush Push Button (Fig. 3)

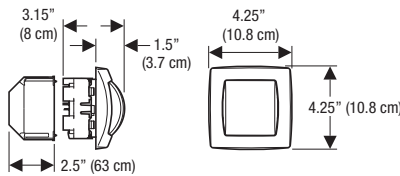

## Finishes

### Single-Flush Actuators

Style	Material	Finish	Model No.
Sigma10	Plastic	White-Polish-White*	115.758.KJ.1
		White-Gold-White*	115.758.KK.1
		White-Matte-Matte*	115.758.KL.1
		Black-Polish-Black*	115.758.KM.1
		Polish-Matte-Polish*	115.758.KH.1
		Matte-Polish-Matte*	115.758.KN.1
Tango	Zinc die cast	Alpine White	115.760.11.1
		Polished Chrome	115.760.21.1
		Matte Chrome	115.760.46.1
		Pergamon	115.760.EP.1
		Satinox	115.760.GM.1
		Matte Palladium	115.760.HC.1
		Oil Rubbed Bronze	115.760.HM.1
		ForeverShine™	115.760.IB.1
		PVD Polished Nickel	
		ForeverShine™	115.760.ID.1
		PVD Brushed Nickel	
		Polished-Matte**	115.760.KA.1
Mambo	Stainless Steel	Brushed SS	115.751.00.1

Rumba	Plastic	Alpine White	115.750.11.1
		Polished Chrome	115.750.21.1
		Matte Chrome	115.750.46.1
		Pergamon	115.750.EP.1
		Satinox	115.750.GM.1

### Cover Plates

Round	Zinc Die-Cast	Alpine White	115.765.11.1
		Matte Chrome	115.765.46.1
	Stainless Steel	Brushed SS	115.798.00.1

### Single-Flush Push Buttons

Square	Plastic	Alpine White	115.991.11.1
		Polish-Matte**	115.991.KA.1

- \* Finishes follow this pattern = Plate-Ring-Button  
Polish = Polished Chrome  
Matte = Matte Chrome  
Br SS = Brushed Stainless Steel
- \*\* Finishes follow this pattern = Frame-Button  
Polish = Polished Chrome  
Matte = Matte Chrome

## Warranty

One-year warranty on actuator flush plates. ForeverShine™ finishes installed in residential-use applications are warranted not to corrode, tarnish or discolor for the life of the Product.

## Features

- Designed to maintain appearance push after push
- Moving parts are accessible behind actuator flush plate
- Made of molded plastic, zinc die cast or stainless steel and plated
- Available in 18 designer finishes
- Initiates flush of 1.6 GPF (6 LPF)



### ARCHITECT/ENGINEER APPROVAL

Job Name \_\_\_\_\_

Date \_\_\_\_\_ Quantity \_\_\_\_\_

Model Specified \_\_\_\_\_

Variations Specified \_\_\_\_\_

Customer/Wholesaler \_\_\_\_\_

Contractor \_\_\_\_\_

Architect \_\_\_\_\_