

Little GIANT®

OPWG-71/97

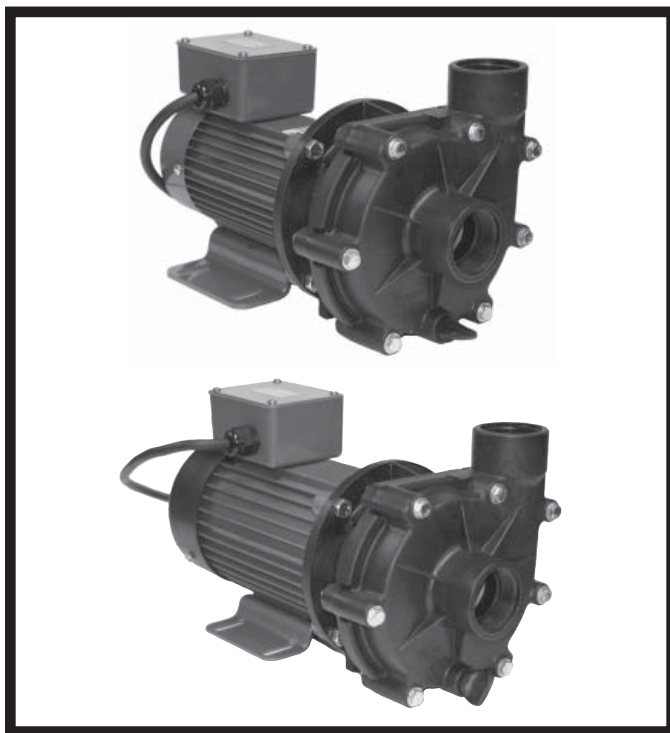

Features

- Thermally protected, enclosed, fan cooled, permanent split capacitor motor
- 115V or 230V operation (pre-wired for 115V)
- 1-1/2" FNPT intake and discharge ports
- Motors are enclosed for excellent protection and weather resistance
- Low power consumption
- For larger systems, plumb two or more units in parallel to economically multiply the flow

Construction

- Volute — Corrosion-resistant thermoplastic
- Volute Cover — Corrosion-resistant thermoplastic
- Impeller — Glass-filled Noryl®
- Shaft Seal — Carbon/Ceramic



Cost-Saving Efficiency

The Little Giant Professional Series of pumps produce a maximum flow rate with minimal electrical consumption. The dollars saved from reduced operating costs can pay for the pump in a matter of months.

Safety

The Professional Series are end suction centrifugal pumps, designed to be located on the perimeter of the pond. This eliminates the need for wading into the pond to service the pump or pump intake filter. By locating the pump outside of the pond, you also greatly reduce the chance of electrical shock.

Reliability

The Professional Series was designed with the professional in mind. Built tough, the pump housings are injection-molded of corrosion-resistant thermoplastics, and are mounted to custom-built motors. Each Professional Series pump is thoroughly tested prior to shipment. When properly installed, your pump is designed to provide years of dependable, reliable service.

Quiet Operation

Install these pumps wherever you desire. The Professional Series was designed for water gardening, not industrial applications, generating noise levels equivalent to a small electrical fan at 52 dB.

NOTE: For above the water level applications, a leaf basket (566106), is required to act as a priming chamber.

OPWG-71/97

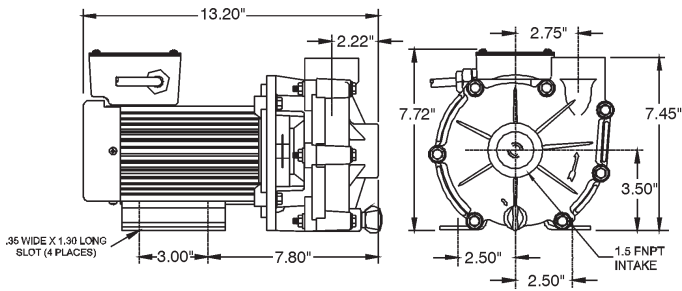

OPWG-71

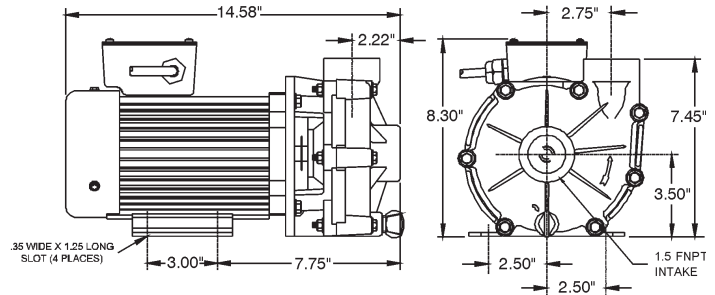

OPWG-97

Specifications

Model No.	Item No.	Listings	Discharge Size	Intake Size	HP	Volts	Hertz	Amps	Watts	Performance (GPM @ Head)				Shut Off		Weight (lbs.)	Height (in.)	Length (in.)	Width (in.)
										5'	10'	15'	20'	Feet	PSI				
OPWG-71	566023	UL/CSA	1-1/2" FNPT	1-1/2" FNPT	1/8	115/230	60	2.5/1.3	257	71	59	45	10	21	8.9	24.86	8.75	15.50	9.00
OPWG-97	566024	UL/CSA	1-1/2" FNPT	1-1/2" FNPT	1/4	115/230	60	3.5/1.7	370	97	84	68	45	22	9.6	24.90	8.75	15.50	9.00

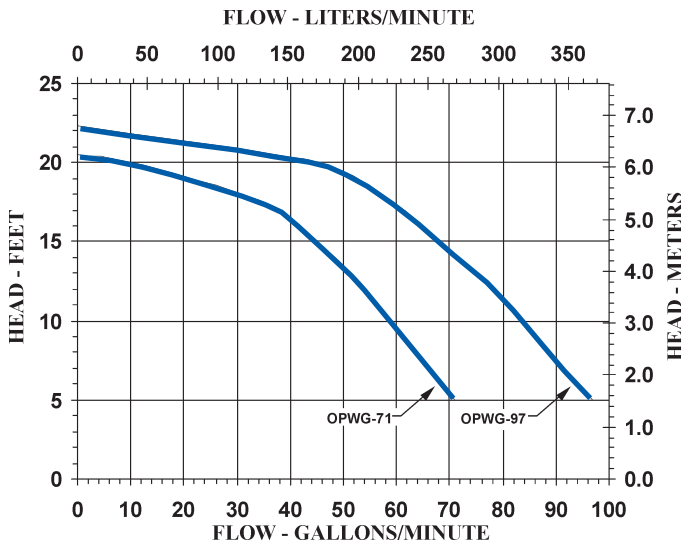

Replacement Parts

166203	Impeller OPWG-71
166204	Impeller OPWG-97
166206	Bracket
166208	Volute
166209	Drain Plug with O-Ring
924042	O-Ring, Volute
926046	Seal Assembly, Ceramic/Carbon