



ENGINEERING EXCELLENCE

Calla Collection #3CL400

PARTS BREAKDOWN SHEET

DESCRIPTION

- Two Handle Lavatory Wide-spread Faucet
- Metal Lever Handles
- Rigid Spout
- 5-5/8" Reach, 4-3/4" from Deck to Aerator
- Ceramic Disc Cartridges
- 3-Hole 6" to 16" Installation
- Brass Pop-Up Drain Assembly

FINISHES

- PC PVD Polished Chrome
- BN PVD Brushed Nickel
- SS PVD Stainless Steel
- PN PVD Polished Nickel



#3CL400 SHOWN * ADA 

STANDARDS APPLICABLE

- ASME A112.18.1
- ANSI A117.1
- ANSI / NSF 61, SECTION 9
- CUPC / IAPMO LISTED / ADA COMPLIANT
- CONTAINS NO MORE THAN 0.25% WEIGHTED AVERAGE LEAD CONTENT

FLOW

- Aerator Limited to 1.5 GPM



Model #: _____

Specific Features: _____

Project Name: _____

Submitted For: _____

Model	Description	Finishes	
#3CL400	Two Handle Lavatory Widespread Faucet	<input type="checkbox"/> PC	<input type="checkbox"/> Other__



ENGINEERING EXCELLENCE

Pioneer: 1-800-338-9468
 Commerce, CA 90040
 www.pioneerind.com
 Pioneer Industries, Inc. © 2013

DMPB3CL400/REV. 12 2012
 Page 1 of 2

	ITEM#	DESCRIPTION
A	X-1300015*	Calla Handle
B	X-4300071	Top Locknut
C	X-4900022	Bonnet Nut
D	X-3300004C	Ceramic Cartridge-Cold
E	X-3300004H	Ceramic Cartridge-Hot
F	X-5900001	Valve Mounting Kit
G	X-4900004	Supply Nut
H	X-4300011	Y Connector
I	X-5300010	Spout Mounting Kit
J	X-4300054	Washer
K	X-2300015*	Calla Spout
L	X-4900099	Aerator Tool
M	X-6300019*	Brass Pop-up Drain Assembly
N	X-5900006	Mounting Tool
1	X-4900108	1.5 GPM Laminar Flow Aerator
2	X-4300072*	Pop-up Lift Rod

* Note: Please specify finish/color when ordering.

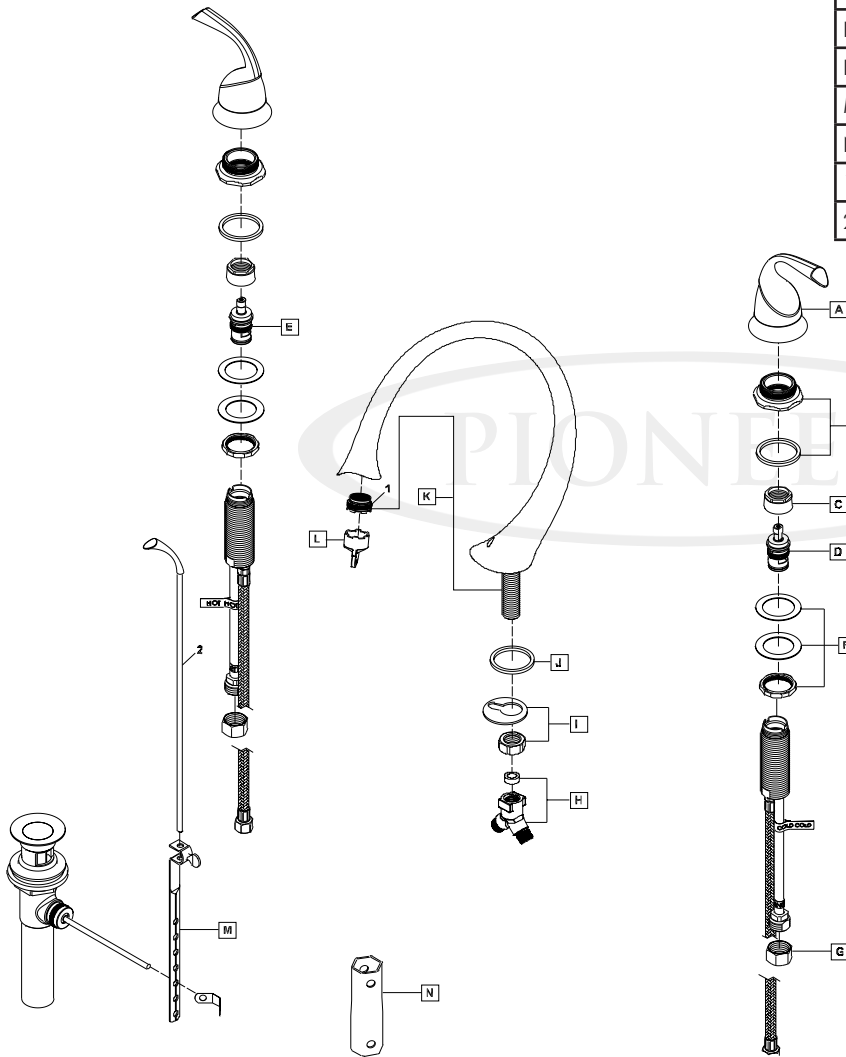

Product Diagram



ENGINEERING EXCELLENCE

Pioneer: 1-800-338-9468

Commerce, CA 90040

www.pioneerind.com

Pioneer Industries, Inc. © 2013