



ENGINEERING EXCELLENCE

Installation Guide

Single Handle Tub And Shower Valve Set:

- 4020B



This product meets the following standards:

- ASME A112.18.1
- ASSE 1016
- CUPC / IAPMO LISTED

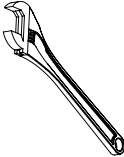

Thank you for purchasing this Pioneer quality product.

Tools Required

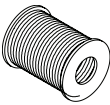
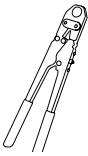
				
Adjustable Wrench	Hacksaw & Pipe Cutter	Propane Torch	Lead-Free Solder	PEX Crimp Tool

Prior to Installation

- Observe all local plumbing and building codes before you begin installation.
- Carefully shut off both hot and cold main water supplies.
- Pioneer reserves the right to make changes in the design of faucets without notice as specified in the pricebook.

Caution: These products may cause personal injury due to scalding if the temperature is set too high. We recommend that temperature is set below 120 ° F (49 ° C).

Valve Installation

1. Determine the location of the valve. Install the required support framing. Determine the distance to set valve to the recommended depth based upon the lines provided for desired trim. These lines designate where the installed valve should be flush with the finished wall. Improper installation may result in performance and aesthetic issues with the product.
2. Remove inlet stop assembly, test cap before soldering.
3. Locate the valve and install 1/2" piping (B) and elbows (A) to bath and shower outlets. Do not use more than one elbow (A) on the spout outlet. Ensure the 'up' marking on the valve face toward the ceiling. If this installation is for bath or shower only, cap shower or bath port accordingly. Do not forget to put the washer underneath of the cap. Apply sealant or teflon tape to threaded connections.

Caution: Do not use PEX or CPVC between the valve and tub spout.

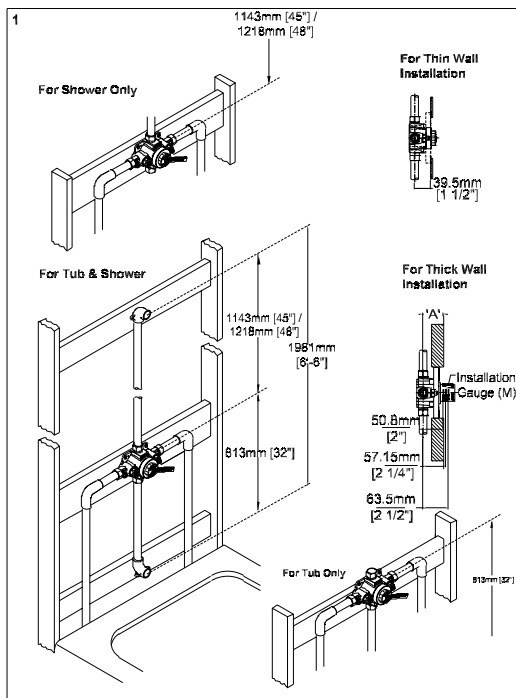

Valve Installation

2

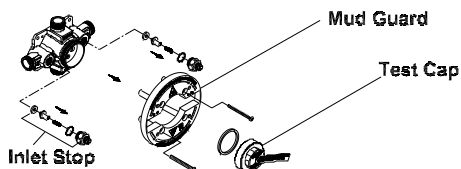

3

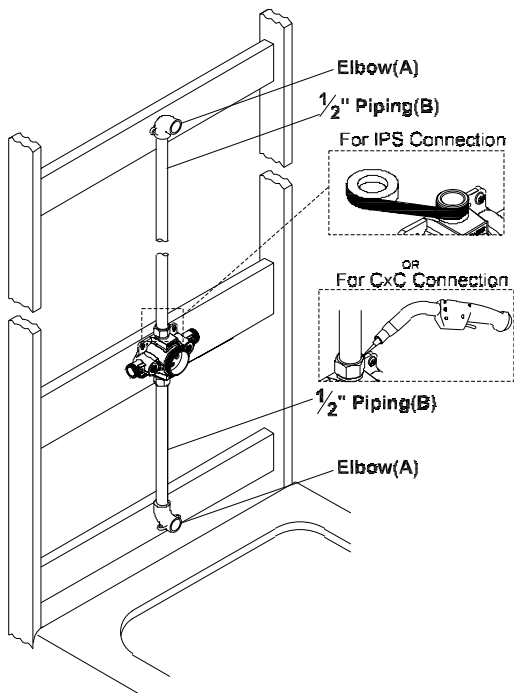

Valve Installation

4. Install hot and cold water supplies (C&D) using 1/2" iron pipe, copper to copper, CPVC or PEX connections.
5. Connect 1/2" pipe nipples (E&F) to bath and shower outlets.
6. Replace the inlet stop assembly and test cap. While replacing the inlet stop do not tighten more than 5lbs/inch². Overtightening may cause damage to the inlet stop.

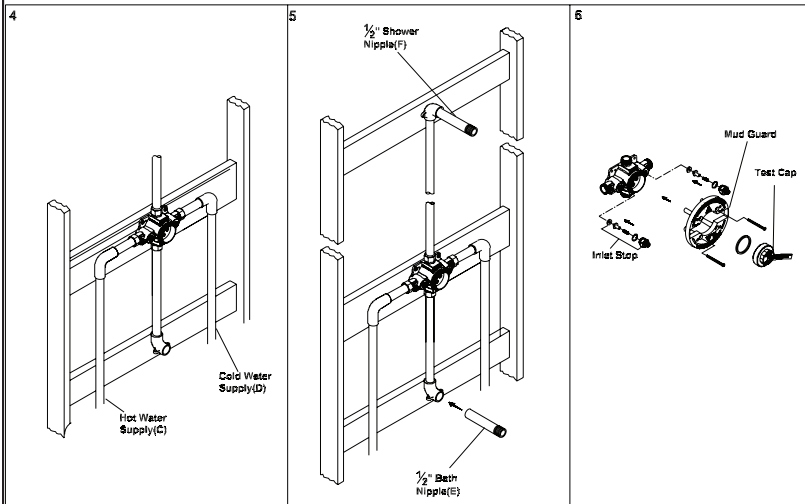

Valve Installation

- Turn on main water supply to flush all the debris then turn off main water supply. For all installations, install caps (L) on the bath and shower nipples (E & F). Turn on the hot and cold water supplies and check for any leaks.
- For thick or thin wall installation refer to the drawings and to Step (1).

7 For All Installations

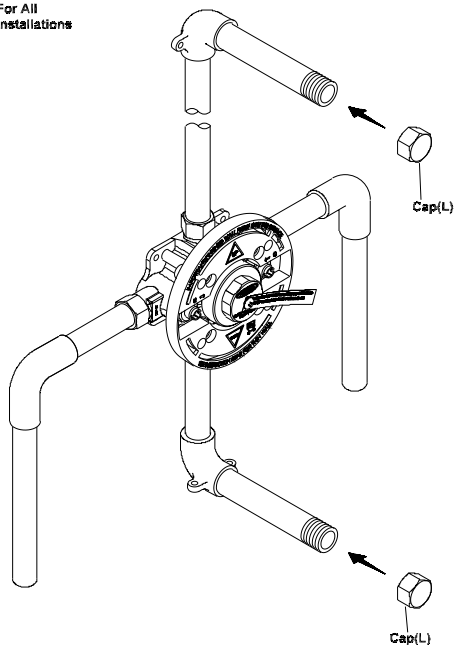

8 For Thick Wall Installation

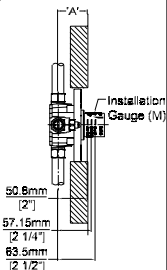
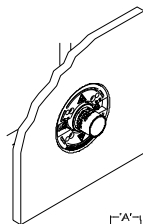

For Thin Wall Installation

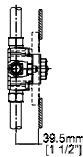

For more care information or trouble shooting inquiries about your Pioneer Product, please see the contact information on the back page.



ENGINEERING EXCELLENCE

3325 S. Garfield Ave. | Commerce, CA 90040
Telephone: (800) 338-9468 | (323) 888-8873 | Fax: (323) 888-9515
Hours: M - F, 7:30am to 5:00pm PST
www.pioneerind.com