



Manufactured from Quartz natural stone  
(see page 2 for detailed information)

Recommended for high use traffic areas and commercial surfaces

WARRANTY  
Limited Lifetime – Residential  
Limited 10-year – Commercial

FEATURES

- Made with 80% quartz stone, only a diamond is harder
- Virtually indestructible, will not damage from kitchen use
- Standard sink size
- Ideal for remodeling or new construction
- Offers design flexibility, installs as a drop-in or undermount

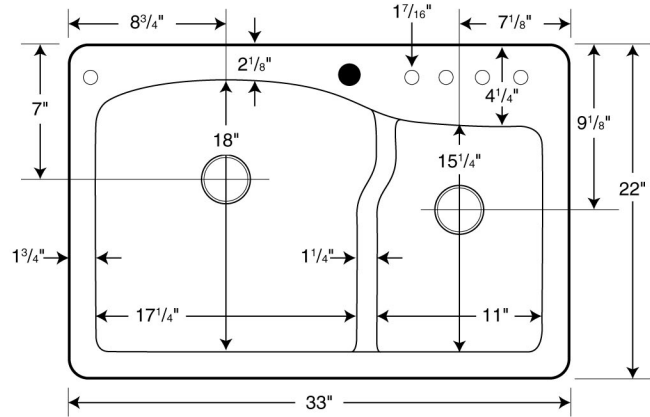
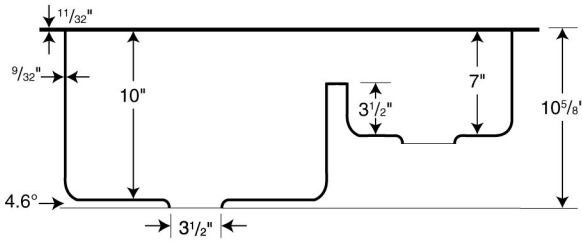

○ Drill Points ● Pre-drilled

SPECIFICATIONS

QZLS-3322 Large/Small Bowl

Model	Part	Dimensions	Ship Wt. Lb.	Ship UPS	Carton Dims. In.	Cu. Ft.
QZLS-3322	QZ03322LS	33" W x 22" D (838 mm x 559 mm)	60	UPS	39 x 26 x 13	7.63

ACCESSORIES

- QZ-22 Cutting Board

STANDARDS AND RATINGS

American National Standard Institute—ANSI Z124.6  
International Association of Plumbing and Mechanical Officials (IAPMO) – listed  
cUPC listed – Certified to CSA Standard B45 by IAPMO  
Heat resistance to 392°F, 200°C

SUPPORT DOCUMENTS

Installation instructions available on line at [www.swanstone.com](http://www.swanstone.com)

COLORS

(See inside back cover for color sample.)

- Bianca (075)
- Granito (076)
- Nero (077)
- Espresso (170) – Available in 2010

MAINTENANCE AND CLEANING INFORMATION

Clean your granite sink by using warm water and a soft cloth, sponge or Mr. Clean Magic Eraser. Non-abrasive liquid cleaners and detergents can also be used. Hard water, calcium and lime deposits can be removed with white vinegar on a paper towel and rinsing after 20 minutes. To restore luster and extend time between cleanings, Weiman's Granite Polish is recommended. Staining liquids such as dyes and vegetable juices should be rinsed off as soon as possible. **Do not** use abrasive cleaners, metal scouring pads, bleach or alkali cleaners such as ammonia.

Undermount clips sold separately. Faucet options are limited to available hole placement. Please contact your dealer for more information.