

END CAPS & END PLUGS

END CAPS*

| DIAMETER | PACKAGE QUANTITY | | TYPE | PRODUCT CODE | |
|-------------|------------------|-------|-------|--------------|--------|
| | SNAP | SPLIT | | SNAP | SPLIT |
| 3" (75mm) | 30 | 32 | Solid | 0332AA | 0331AA |
| 4" (100mm) | 40 | 34 | Solid | 0432AA | 0431AA |
| 5" (125mm) | | 24 | Solid | | 0531AA |
| 6" (150mm) | | 12 | Solid | | 0631AA |
| 8" (200mm) | 6 | | Solid | 0832AA | |
| 10" (250mm) | 6 | | Solid | 1032AA | |
| 12" (300mm) | | 4 | Solid | | 1267AA |
| 15" (375mm) | | 1 | Solid | | 1567AA |
| 18" (450mm) | | 1 | Solid | | 1867AA |
| 24" (600mm) | | 1 | Solid | | 2467AA |

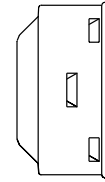

SNAP END CAP

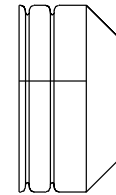

SPLIT END CAP 3"-10"



SPLIT END CAP 12"-24"

**END CAPS ARE FOR HORIZONTAL APPLICATIONS ONLY. END CAPS ARE NOT PERMITTED TO BE USED IN ANY VERTICAL APPLICATIONS. MISUSE OR FAILURE TO PROPERLY SECURE END CAPS MAY RESULT IN DAMAGE TO PERSONS OR PROPERTY OR MAY RESULT IN INJURY OR DEATH.*

INTERNAL SNAP PLUGS

| DIAMETER | PACKAGE QUANTITY | PRODUCT CODE |
|------------|------------------|--------------|
| 3" (75mm) | 16 | 0332AAIN |
| 4" (100mm) | 34 | 0433AAHAN |
| 5" (125mm) | 24 | 0533AAHAN |
| 6" (150mm) | 50 | 0633AAHAN |

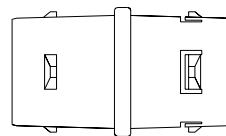

INTERNAL SNAP PLUG

INTERNAL END PLUGS

| DIAMETER | PACKAGE QUANTITY | TYPE | PRODUCT CODE |
|------------|------------------|------------|--------------|
| 3" (75mm) | 100 | Solid | 0333AA |
| 4" (100mm) | 100 | Solid | 0433AA |
| | | Perforated | 0434AA |
| 5" (125mm) | 100 | Solid | 0533AA |
| 6" (150mm) | 50 | Solid | 0633AA |

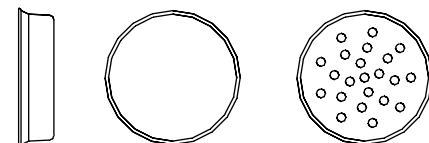

INTERNAL END PLUG - SOLID AND PERFORATED