



SERVICE PARTS LIST

BULLETIN NO.
54-08-1155

SPECIFY CATALOG NO. AND SERIAL NO. WHEN ORDERING PARTS		REVISED BULLETIN 54-08-1154	DATE Jan. 2013
1/2" REVERSING DRILL			
CATALOG NO.	1001-1	STARTING SERIAL NO.	491E
		WIRING INSTRUCTION 58-01-0297	

EXAMPLE:
Component Parts (Small #) Are Included
When Ordering The Assembly (Large #).

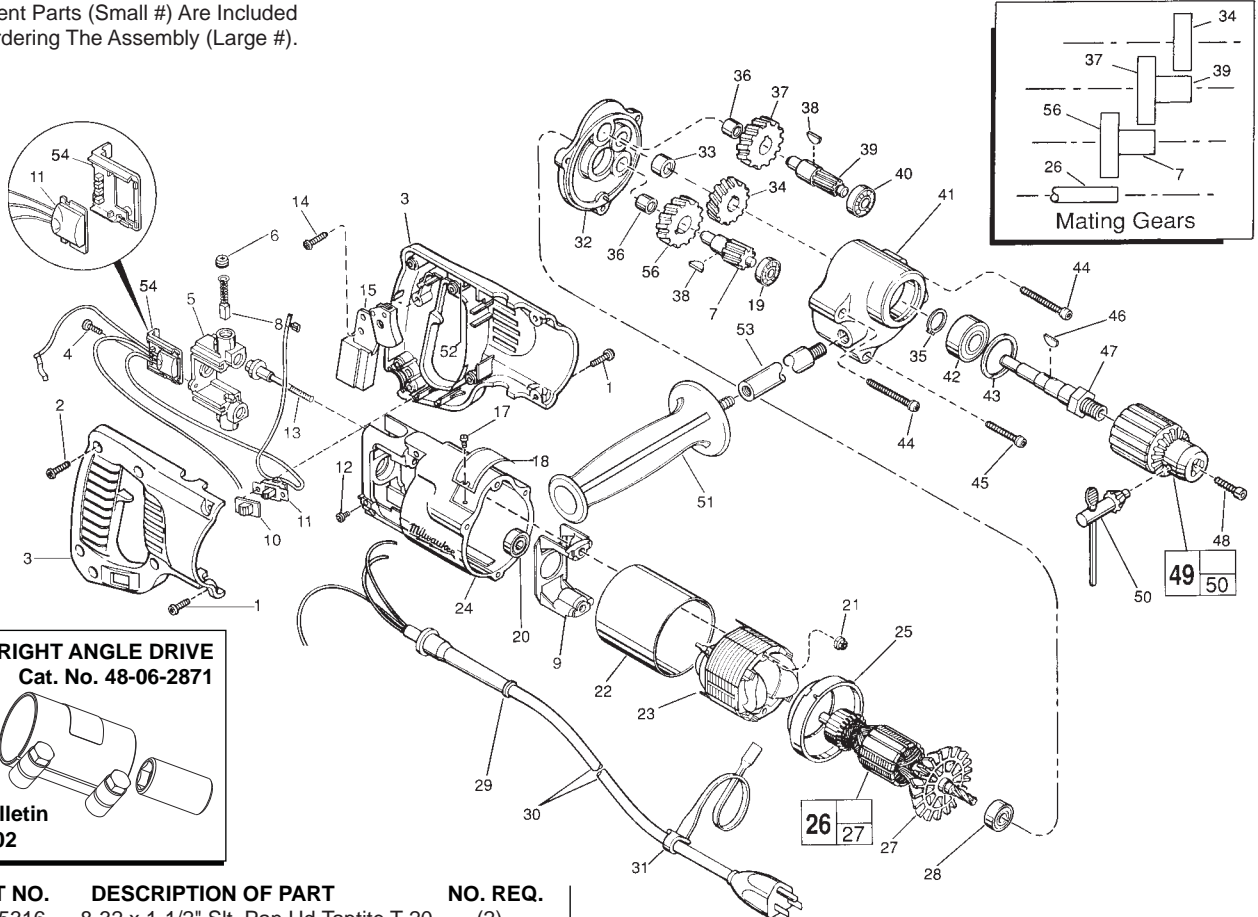

RIGHT ANGLE DRIVE
Cat. No. 48-06-2871

See Service
Parts List Bulletin
No. 54-36-0602

FIG.	PART NO.	DESCRIPTION OF PART	NO. REQ.
	1	06-82-5316 8-32 x 1-1/2" Slit. Pan Hd. Taptite T-20	(2)
	2	06-82-7270 8-16 x 5/8" Slit. Pan Hd. Plastite T-20	(5)
★	3	31-44-1680 Right and Left Handle Halves	(1)
	4	06-95-0075 6-32 x 3/8" Truss Hd. Taptite	(2)
	5	22-22-1380 Brush Holder Assembly	(1)
	6	23-44-0190 Brush Retaining Cap	(2)
	7	36-66-2811 Intermediate Shaft	(1)
	8	22-18-0910 Carbon Brush Assembly	(2)
	9	31-55-0190 Coil Shield	(1)
	10	31-12-0196 Switch Cap	(1)
★	11	14-20-0367 Switch Assembly	(1)
	12	06-95-5150 6-32 x 1/4" Hex Hd. Taptite Sems	(1)
	13	06-81-1060 8-32 x 2-1/4" Field Bolt	(2)
	14	06-82-7270 8-16 x 5/8" Slit. Pan Hd. Plastite T-20	(1)
	15	23-66-1965 On-Off Switch	(1)
	17	06-72-1720 Nameplate Rivet	(2)
	18	12-99-1750 Service Nameplate	(1)
	19	02-04-0640 Ball Bearing	(1)
	20	02-04-0845 Ball Bearing	(1)
	21	06-57-2975 8-32 Hex Nut	(2)
	22	23-16-0456 Field Insulator	(1)
	23	18-31-0600 120 Volt Field - Auto Assembly	(1)
	24	28-50-6220 Motor Housing	(1)
	25	31-05-0055 Baffle	(1)
	26	16-30-0226 120 Volt Armature	(1)
	27	22-84-0531 Fan Assembly	(1)
	28	02-04-0911 Ball Bearing	(1)
	29	44-76-0210 Cord Protector	(1)
	30	22-64-3190 Cord Set	(1)
	31	48-66-4040 Key Holder	(1)
	32	28-28-0611 Diaphragm	(1)
	33	02-50-2440 Needle Bearing	(1)
	34	32-75-2066 Spindle Gear	(1)
	35	34-60-1200 Retaining Ring	(1)

FIG.	PART NO.	DESCRIPTION OF PART	NO. REQ.
	36	02-50-1640 Needle Bearing	(2)
	37	32-75-2051 2nd Intermediate Gear	(1)
	38	06-42-0800 Woodruff Key	(2)
	39	36-66-4012 2nd Intermediate Shaft	(1)
	40	02-04-0820 Ball Bearing	(1)
	41	28-14-1922 Gear Case	(1)
	42	02-04-1536 Ball Bearing	(1)
	43	34-80-2500 Retaining Ring	(1)
	44	06-82-5532 8-32 x 2-1/2" Slit. Pan Hd. Taptite T-20	(2)
	45	06-82-5432 8-32 x 1-5/8" Slit. Pan Hd. Taptite T-20	(1)
	46	06-42-2000 Woodruff Key	(1)
	47	38-50-5475 Spindle	(1)
	48	06-75-3150 1/4-20 x 1" L.H. Skt. Cap Screw	(1)
	49	48-66-1360 1/2" Chuck	(1)
	50	48-66-3280 Chuck Key	(1)
	51	43-62-1265 Side Handle	(1)
	52	14-46-1001 Foam Slug Kit-(10 Slugs)	(1)
	53	43-62-1170 Side Handle Extension	(1)
	54	43-72-0176 Heat Sink Holder	(1)
	56	32-40-1251 Intermediate Gear	(1)

FIG. LUBRICATION

41 3-3/4 Oz. Type "A" Grease, 49-08-0800.

FIG. NOTES:

51 Apply Red Loctite To Threads Of Side Handle.