

# SYMMONS® ORIGINS®

## Lavatory Faucet

### S-244 Series

#### INSTALLATION, OPERATION AND SERVICE

#### INSTRUCTIONS

Faucet meets ASME A112.18.1/CSA B125.1, NSF/ANSI 61.9, NSF/ANSI 372, WaterSense at 1.0 gpm & 1.5 gpm

Standard flow rate: 2.2 gpm (8.3 L/min)



**Caution: Be sure to turn off hot and cold water supplies before installing or servicing faucet.**

#### INSTALLATION:

1. Push valve bodies through holes in sink from underneath. Make sure flange nuts and mounting washers are on underside of sink. Valve with red striped hose (hot) is on the left and blue (cold) is on the right. Put gasket (LN-129) over valve body. Thread escutcheon (LN-128) onto valve bodies. The top of the valve spindle should measure 1-7/8" from mounting surface (See rough in drawing).
2. Thread collar (LN-112 or LN-160) on to valve body until it reaches the escutcheon (LN-128). Tighten flange nuts from underneath sink. Secure with mounting screws if necessary.
3. LCT or LWG handle installation: Place bushing (LN-115 or LN-154) on valve spindle. Turn valves to off position (LCT style: turn clockwise, LWG, LCF, LPO and LAM style: turn hot clockwise, turn cold counterclockwise). Place handle (LN-131 or LN-151) on bushing. Thread screw (LN-146 or LN-121) into valve and push plug button (T-33R and T-33B) into top of handle. LCF, LPO and LAM handle installation: Place lever part of handle on valve spindle and thread screw (LN-134) into valve.
4. Install spout (LN-124) and centerbody (LN-141) through center in sink hole from above sink. Secure spout to sink with washer (LN-138) and nut (SPF-26). Washer (LN-138) flat should face back of the sink. Thread tee (LN-141) to bottom of centerbody (LN-141).
5. Thread flex hose adapters into tee (LN-141) using pipe sealant or teflon tape on the adapter threads. Attach flex hoses to flex hose adapters.
6. Connect hot supply to left tube and cold supply to right tube using appropriate connectors.
7. Pop-up drain installation:
  - a) Remove pop-up plug, tail piece and flange from the drain body. Make sure that locknut is threaded all the way down onto the body with flat friction washer in middle and beveled washer on top.
  - b) Apply plumbers putty or sealant to bottom of flange.
  - c) Install drain body through drain opening in lavatory and screw flange onto the drain body making sure that the threads are completely engaged for proper sealing and strength of the connection. Apply joint compound to all threaded parts to insure proper seal. Apply putty or teflon tape to tail piece before attaching to drain body.
  - d) Tighten locknut to compress the beveled flange evenly across the bottom of the drain opening taking care not to over tighten the locknut, causing damage to the lavatory.
  - e) Remove one of two ball washers from inside the threaded cavity. Insert pop-up plug and pivot rod into body. Add one ball washer (the second ball washer should remain inside the body) to the outside of the ball. Tighten the retaining nut until the ball is seated on the internal and external ball washers. Note: The pop-up plug can be installed in the removable or non-removable position, depending on the location of the hole located in the guide at the bottom of the plug.
  - f) Slide the pivot rod through one side of the spring clip, then the appropriate adjustment hole and then other side of the spring clip.
  - g) Insert lift rod through faucet housing and the top of the lift strap and secure it in place by tightening the screw. Note: To

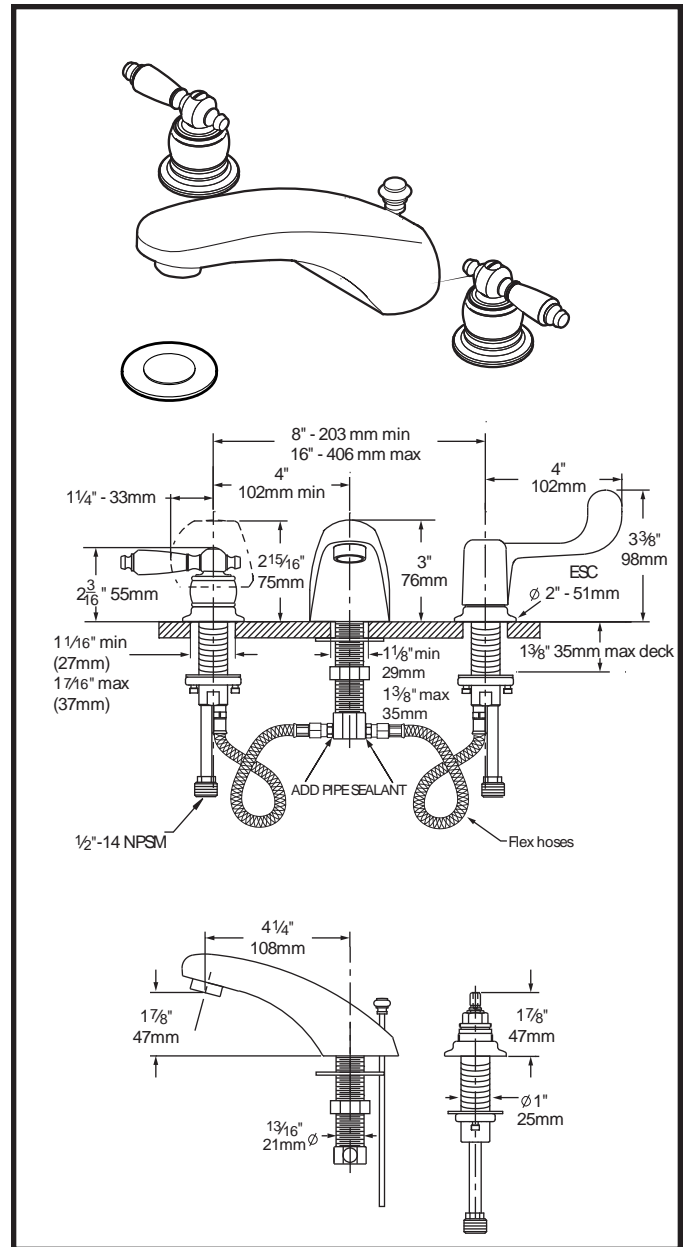

insure proper operation of lift rod and pop-up, some adjustment of the linkage may be required. There are two possible adjustment points: 1) lift strap to lift rod and 2) lift strap to pivot rod.

8. It is very important to thoroughly flush the supply lines to prevent foreign matter, i.e. copper chips, sand, stones, etc. from damaging the sealing surfaces of cartridge. Remove aerator and open hot and cold to full open then open both supplies. Let water run through hot and cold long enough to flush supply lines thoroughly. Shut off faucet and replace aerator. Check for leaks.

#### To replace cartridge (KN-113 or KN-114):

1. Remove plug button (T-33, T-33R or T-33B), loosen Philip head screw (LN-121) and remove handle, LN-131, LN-151 or LN 152.
2. Remove collars LN-160 or LN-112 by turning counter clockwise, do not use wrench as this may damage the surface finish.
3. Place wrench on cartridge hex nut (KN-113, KN-114). Turn wrench counter clockwise until cartridge is removed.
4. Install new cartridge. Turn cartridge with wrench until cartridge does not turn easily then turn 1/4 to 1/2 turn further. Reassemble handle in reverse fashion.

- DF-30\* Finial, lever, Handle (2)
- LN-138 Washer
- KN-113 Valve cartridge, cold
- KN-114 Valve cartridge, hot
- L-42 Nut (2)
- LN-15\* Aerator
- LN-111\* Lock ring (2)
- LN-112\* Collar (lever handle) (2)
- LN-115 Bushing (2)
- LN-121 Philips pan head screw (2)
- LN-124\* Spout
- LN-127 Gasket, Spout
- LN-128\* Escutcheon, valve (2)
- LN-129 Gasket, Escutcheon (2)
- LN-131 ADA handle (2)
- LN-133A Temperature indicator (red)
- LN-133B Temperature indicator (blue)
- LN-134\* Oval Philips head screw (2)
- LN-138 Washer
- LN-141 Centerbody
- LN-146 Screw (2)
- LN-149 Clear, Lever, Handle (2)
- LN-150 O-ring (2)
- LN-151 Handle, Acrylic (2)
- LN-152\* Lever, Handle (2)
- LN-153A White, Lever, Handle (2)
- LN-153B Chrome, Lever, Handle (2)
- LN-154 Bushing, Acrylic (2)
- LN-160\* Collar (acrylic handle) (2)
- LN-100 Aerator (vandal resistant 0.5 gpm)
- LN-101\* Aerator (vandal resistant)
- RL-154\* Pop-up drain assembly
- P-26\* Grid drain assembly (complete)
- SPF-26 Nut, Hex
- T-33\* Plug Button (2)
- T-33B Plug Button, Blue
- T-33R Plug Button, Hot

\*For Decorative Finish Faucets add suffix to parts marked with an asterisk as follows:

- Suffix BRS: Radiance® polished brass finish
- Suffix STN: Satin finish

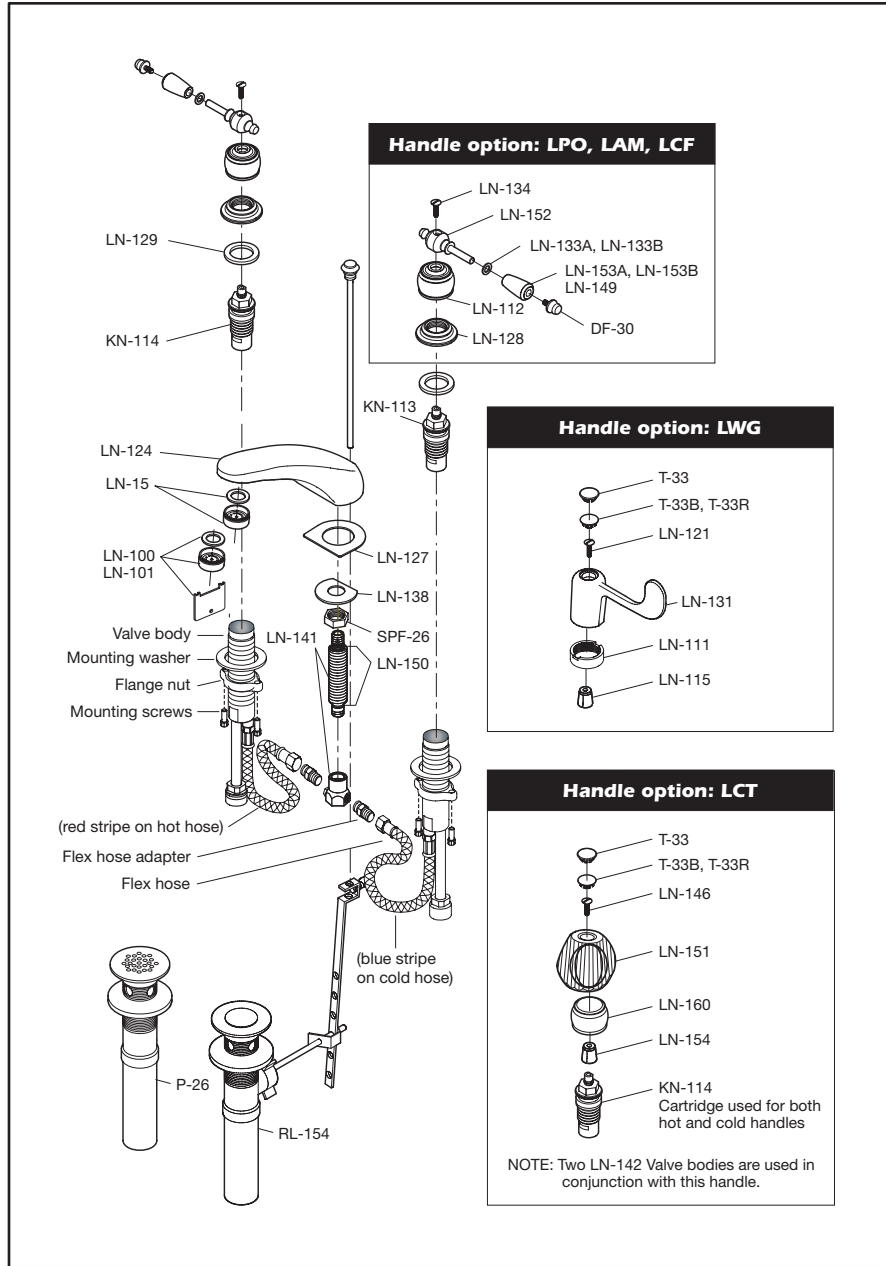

### Lifetime Limited Warranty

Symmons warrants to the original consumer purchaser that any TEMPTROL® series\* or ORIGINS product will be free of defects in material and workmanship during normal domestic use for the life of your home. All other products and purchasers including industrial, commercial or business use are warranted for a period of 5 years from the date of purchase. At our option, we will either have you send the defective part or product prepaid to us for inspection, or we may elect to send you the replacement part or product without investigation. A replacement for any defective part will be supplied FREE OF CHARGE for installation by the purchaser. Defect or damage caused by the use of replacement parts other than Symmons Genuine Replacement Parts will void this warranty. This warranty excludes product damage due to installation error, product abuse, or product misuse whether performed by a contractor, service company or yourself.

Symmons further warrants that any TEMPTROL or SYMMETRIX product will be leak free and drip free during normal domestic use for the life of your home. If the product should develop a leak or drip, Symmons will provide FREE OF CHARGE the parts necessary to return it to good working condition.

Proof of purchase (original sales receipt) and a copy of the warranty registration card from the original consumer purchaser must accompany all warranty claims. This warranty is applicable only to Symmons TEMPTROL or SYMMETRIX products purchased after July 1, 1998 and shall be effective from the date of purchase as shown on the purchaser's receipt.

Damage to the chrome and/or other decorative finishes on Symmons products may be a result of improper handling or abusive treatment. Finishes should only be cleaned with a soft, damp cloth or sponge. Use of polish, abrasive cleaners, solvents, or acid cleaners will damage the finish and void this warranty.

There are no other express warranties on this product and ALL WARRANTIES OF MERCHANTABILITY AND OTHER IMPLIED WARRANTIES ARE LIMITED IN ACCORDANCE WITH APPLICABLE LAW. SYMMONS INDUSTRIES, INC., EXPRESSLY DISCLAIMS CONTINGENT LIABILITY AND CONSEQUENTIAL DAMAGE OF EVERY KIND. Since some states do not allow limitations on how long an implied warranty lasts or an exclusion or limitation of incidental or consequential damages the above limitation or exclusion may not be applicable. This warranty gives specific legal rights. Other rights may vary from state to state.

To obtain warranty service, write to Symmons Industries, Inc., 31 Brooks Drive, Braintree, MA 02184-3804 or call our Customer Service Department at 1-800-SYMMONS. If writing to us, please include proof of purchase, the model number of the product with a brief description of the problem, your name, address and phone number.

\*Temptrol series includes Allura®, Olde Braintree Brass®, Temptrol, Temptrol Deluxe and Temptrol II shower and tub/shower systems.

Symmons warrants to the original consumer purchaser that any TEMPTROL® series\* or SYMMETRIX® product will be free of defects in material and

workmanship during normal domestic use for the life of your home. All other products and purchasers including industrial, commercial or business use are warranted for a period of 5 years from the date of purchase. At our option, we will either have you send the defective part or product prepaid to us for inspection, or we may elect to send you the replacement part or product without investigation. A replacement for any defective part will be supplied FREE OF CHARGE for installation by the purchaser. Defect or damage caused by the use of replacement parts other than Symmons Genuine Replacement Parts will void this warranty. This warranty excludes product damage due to installation error, product abuse, or product misuse whether performed by a contractor, service company or yourself.

Symmons further warrants that any TEMPTROL or SYMMETRIX product will be leak free and drip free during normal domestic use for the life of your home. If the product should develop a leak or drip, Symmons will provide FREE OF CHARGE the parts necessary to return it to good working condition.

Proof of purchase (original sales receipt) and a copy of the warranty registration card from the original consumer purchaser must accompany all warranty claims. This warranty is applicable only to Symmons TEMPTROL or SYMMETRIX products purchased after July 1, 1998 and shall be effective from the date of purchase as shown on the purchaser's receipt.

Damage to the chrome and/or other decorative finishes on Symmons products may be a result of improper handling or abusive treatment. Finishes should only be cleaned with a soft, damp cloth or sponge. Use of polish, abrasive cleaners, solvents, or acid cleaners will damage the finish and void this warranty.

There are no other express warranties on this product and ALL WARRANTIES OF MERCHANTABILITY AND OTHER IMPLIED WARRANTIES ARE LIMITED IN ACCORDANCE WITH APPLICABLE LAW. SYMMONS INDUSTRIES, INC., EXPRESSLY DISCLAIMS CONTINGENT LIABILITY AND CONSEQUENTIAL DAMAGE OF EVERY KIND. Since some states do not allow limitations on how long an implied warranty lasts or an exclusion or limitation of incidental or consequential damages the above limitation or exclusion may not be applicable. This warranty gives specific legal rights. Other rights may vary from state to state.

To obtain warranty service, write to Symmons Industries, Inc., 31 Brooks Drive, Braintree, MA 02184-3804 or call our Customer Service Department at 1-800-SYMMONS. If writing to us, please include proof of purchase, the model number of the product with a brief description of the problem, your name, address and phone number.

\*Temptrol series includes Allura®, Olde Braintree Brass®, Temptrol, Temptrol Deluxe and Temptrol II shower and tub/shower systems.

### For California Residents

**WARNING:** This product contains chemicals known to the State of California to cause cancer, birth defects, or other reproductive harm.

Symmons Industries, Inc. ■ 31 Brooks Drive ■ Braintree, MA 02184  
 Phone: (800) 796-6667 ■ Fax: (800) 961-9621  
 Website: symmons.com ■ Email: gethelp@symmons.com

Copyright © 2017 Symmons Industries, Inc. ■ ZV-364 REV E ■ 082817

