



Watco Manufacturing Co. Trip Lever Installation Instructions for

QUICK ADJUST® • SLIP LOCK® • TURNSTYLE®

See reverse side for general trip lever instructions.

QUICK ADJUST® Trip Lever

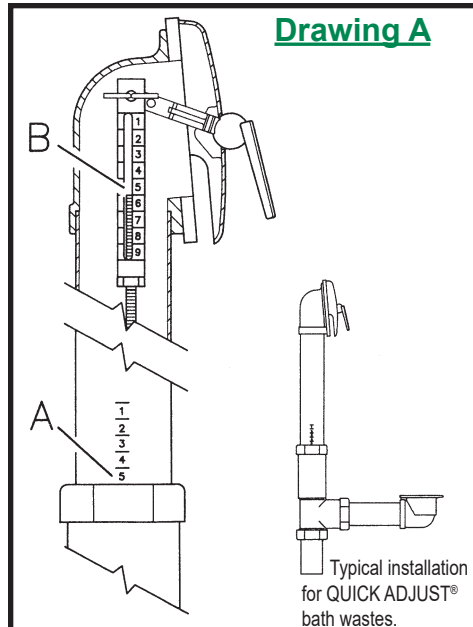

- A. Establish rough-in length at overflow elbow scale.
- B. Adjust nut on threaded-rod on the linkage clevis until the number matches the number on the overflow elbow scale.
- B. Tighten nut securely.

Drawing B

All trip-lever drains:

Make sure brass linkage is not kinked.

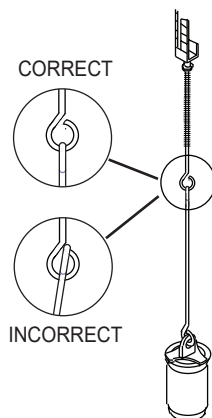

SLIP LOCK® Trip Lever

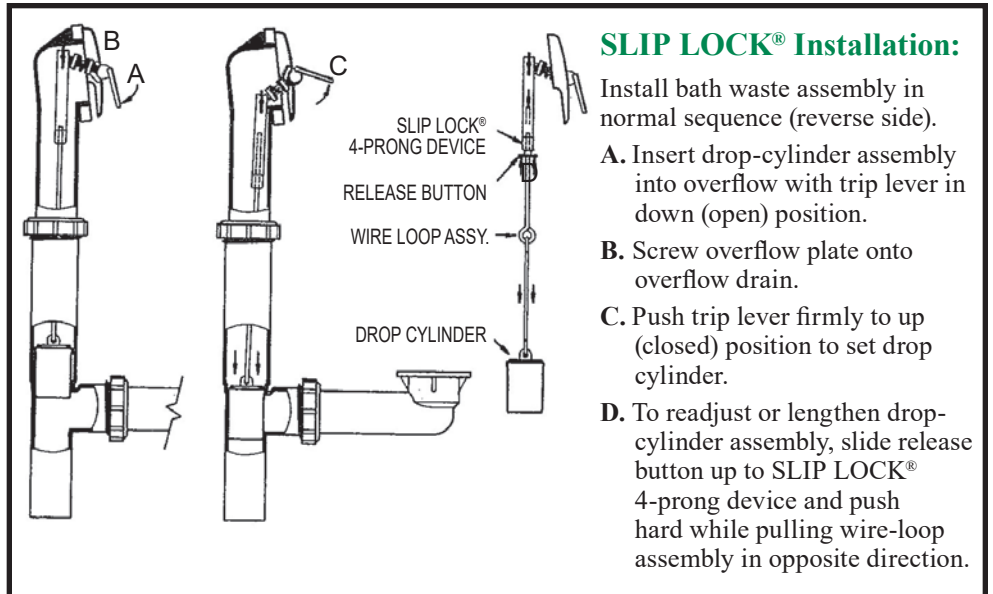

TURNSTYLE® Trip Lever

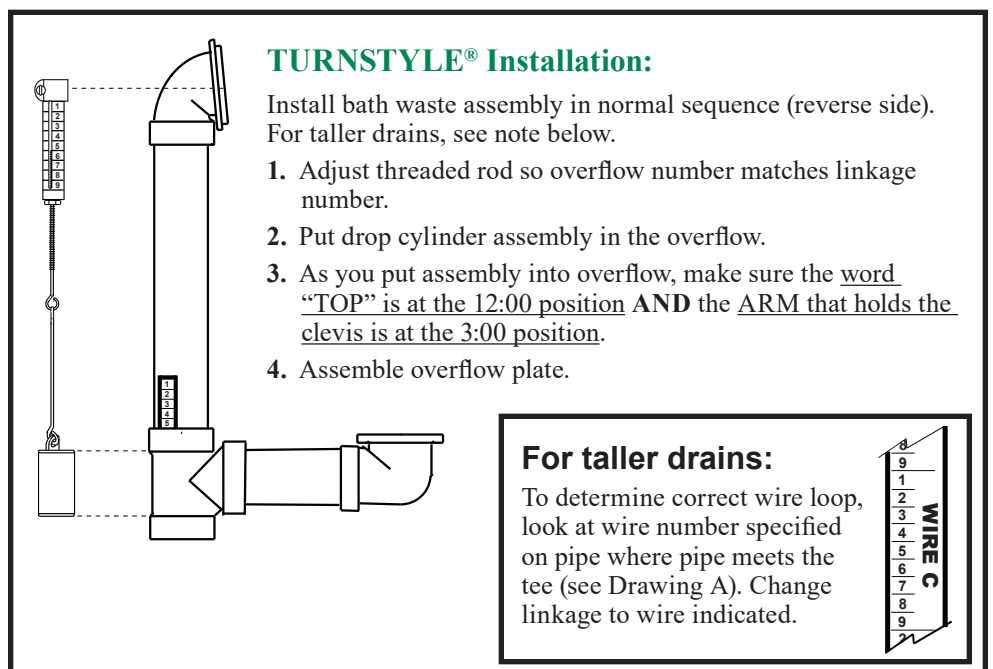

See watcomfg.com or call for details of applicable patents and patents pending.

WATCO MANUFACTURING COMPANY

1220 South Powell Road • Independence, MO 64057-2724

Phone: 816-796-3900 • 800-821-8576

Fax: 816-796-0875 • 800-399-2826

www.watcomfg.com

IMPORTANT!

On Schedule 40 trip lever bath wastes, the arrow on tee must be pointing down. Do not allow solvent cement to enter tee cavity.