

# Schedule 40



Square Overflow  
01007CP

Model 900  
Model 920

Not Shown: Half Kits (No Tee or Pipe)

**Model 901:** Stoppers, Knobs, Strainer Bodies determined by type of tub closure, i.e., Lift and Turn, etc.

**Model 921-PP:** ABS Stopper, Plastic Knob, Brass Strainer Body, Chrome PP only

**Model 951-PP:** ABS Stopper, Plastic Knob, Zinc Strainer Body, Chrome PP only



**ADA**

PRESFLO® (PF)  
Foot Actuated (FA) only



Includes built-in  
test membrane



Easily remove  
membrane after test



Snap-on  
overflow plate.  
No screws

See price list for complete item numbers and available options.

When ordering, please specify complete item number and any applicable option codes.

**WATCO**



Always a step ahead

For More Information Contact:  
**WATCO Manufacturing Company**  
1220 South Powell Road  
Independence, MO 64057-2724  
Ph. 816-796-3900 • FAX 816-796-0875  
[www.watcomfg.com](http://www.watcomfg.com)

## Innovator® 900/901

Stoppers, Knobs, and Bodies determined by tub closure selected

## Innovator® 920/921

ABS Plastic Stopper, Plastic Knob, Brass Body, Chrome PP only

## Innovator® 951 Half Kit

ABS Plastic Stopper, Plastic Knob, Zinc Body, Chrome PP only

**Sturdy 1.5" Schedule 40 PVC or ABS  
Solvent Weld Assembly**

### SPECIFICATIONS

#### FEATURES:

- Eliminates all screws
- Eliminates need for separate overflow test plug
- Eliminates leaks due to loose overflow attachment
- Eliminates dual inventory of one- and two-hole overflow plates

#### APPROVALS (900/901 models):

- Manufactured in compliance with ASME A112.18.2-2005/CSA B125.2-2005.

#### PATENTS (Innovator®):

- <https://www.watcomfg.com/patents>

#### THREADS (Strainer Body and Drain Elbow):

- 1½" – 11½ NPSM (Coarse Thread)
- 1.865" Major Diameter (outside thread diameter)
- 11.5 threads per inch

#### PIPING: ☐ PVC ☐ ABS

#### ROUGH-IN (RI's) and STOPPER/FACEPLATE (SF's)

#### STOPPER/FACEPLATE'S

(example: 900-PPSF-0-CP)

Overflow plate and  
stopper assembly

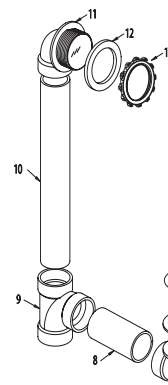
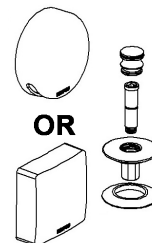

#### ROUGH-IN'S

(example: 900-PPRI-PVC-CP)

All parts, including strainer body, except the overflow plate and stopper assembly