

Broan – NuTone Fan Replacement Parts

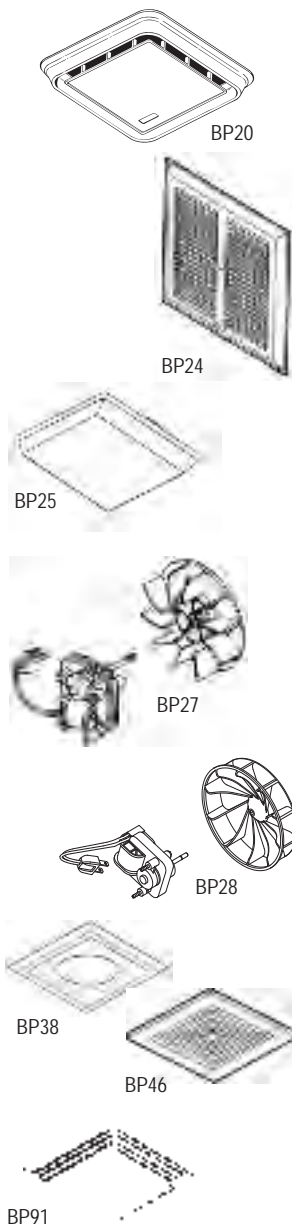

Model No.	Description	Std. Pk.
BP20	Grille — Bath Fan (663, 670, 671, 675, 688 and 689)	6 *
BP24	Grille — Bath Fan (Metal) (660, 662, 664, 665, 666 and 668)	15 *
BP25	Light Lens — Fan/Light (678, 679, 679FL, 655, 656, 657, 659, 695 and 696)	6 *
BP27	50 CFM Bath Fan Motor and Blower Wheel — Compatible with Broan 662, 668, 678-A, B, C, D, E, F and 688-A, B, C, D, E; Nautilus N678-A, B, C, D, E and N688-A, B, C	6 *
BP28	Motor/Wheel — 70 CFM (655, 657, 658, 679, 671 and 671-A)	6 *
BP33	Grille — Spring-Mounted (AC2650, AC2660, AC2900, 7550 and 7650)	6 *
BP34	Grille — Center Screw-Mounted (Aubrey 7570)	6 *
BP35	Grille/Knob — Utility Fan (8")	12 *
BP36	Light Lens (AC2550, AC25501C and 682L)	5 *
BP38	Grille — Single Bulb Heater	10 *
BP46	Grille Assembly — Spring-Mounted (663, 670, 671, 675, 688, 689, Sears and others)	12 *
BP50	Motor/Wheel — 50 CFM (663N, 663LN, and 696N ver. A)	6 *
BP51	Motor/Wheel — 70 CFM (694 and 695 ver. A)	6 *
BP90	Replacement Grille for 688 Fan	4 *
BP91	Replacement Grille and Light Lens — Each grille and light lens is individually poly bagged and labeled with installation guide. Grille and Light Lens — Fits Fan/Light for Broan 678, 679, 679FL, 679FLT, 680, 680FL, 680FLT, HD50L, HD80L, FL2679FT and FL2680FT; NuTone HD50LNT and HD80LNT; Nautilus N678, N679, N679FL and N680. Light Lens Only — Broan 655, 656, 657, 659, 695, 696 and 707; Nautilus N707.	4 *
C350BN	50 CFM Replacement Motor/Wheel (NuTone 696N A housing)	1
C350GN	Grille — NuTone 695 and 696N with 8" x 7-1/4" housing	4 *
C370BN	70 CFM Replacement Motor/Wheel (NuTone 695 A housing)	1
CVG4	4" Grille	1
CVG6	6" Grille	1
CVL4	4" Sleeve	1
CVL5	Grille Sleeve for 5" Round Duct	1
CVL6	6" Sleeve	1
CVLD4	4" Sleeve with Damper	1
CVLD6	6" Sleeve with Damper	1
G686N	Grille for NuTone 686	4 *
RG4	Grille for NuTone 8832SA	1
834	Filter for 8" Exhaust Fans (807C, 821C, 822C and 831C)	1
854	Filter for 10" Exhaust Fans	6 *

For model specific information, please refer to Broan Retail Parts publication (No. 99850402).

