

**HANDLE ASSEMBLY**

P/N: 7381556-400.XXX0A

**TO REMOVE HANDLE ASSEMBLY:**

- Remove electronic tank top unit by lifting lid and turning quarter turn screws *counterclockwise* to the Unlock position and lifting upwards (see **FIGURE 1**)
- Unclip hair pins from clevis pins; remove both clevis pins from red and black arms (see **FIGURE 2**)
- Remove metallic retaining nut by turning *clockwise*; remove kickstand and two lever arms (see **FIGURE 3**)
- Remove plastic retaining nut by turning *clockwise*
- Pull handle assembly away from tank

**TO RE-INSTALL HANDLE ASSEMBLY:**

- Insert handle assembly into hole opening in front of tank
- Tighten plastic retaining nut by turning *counterclockwise*
- Install lever arms (black arm first followed by red arm) then kickstand; verify orientation is correct (see **FIGURE 4**). Tighten metallic retaining nut by turning *counterclockwise* (see **FIGURE 3**)
- Attach bead chain to black arm and yoke to red arm; insert clevis pins into red and black arms; insert hair pins into clevis pins (see **FIGURE 2**)
- Place tank top unit on top of tank and secure by locking unit in place using quarter turn screws (see **FIGURE 1**)

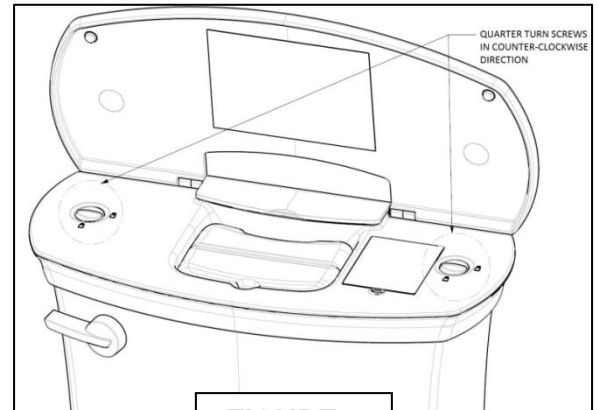

**FIGURE 1**

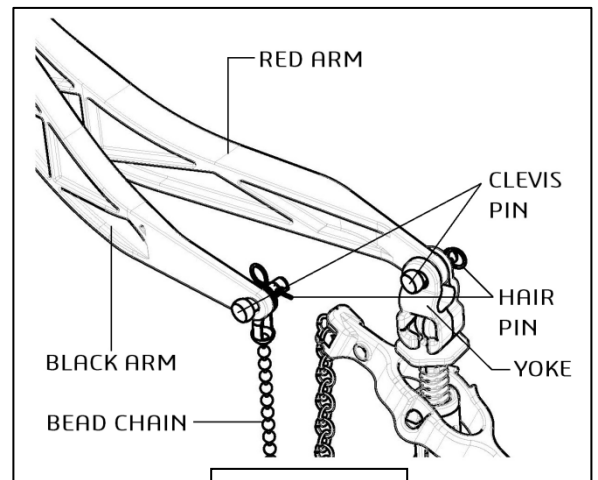

**FIGURE 2**

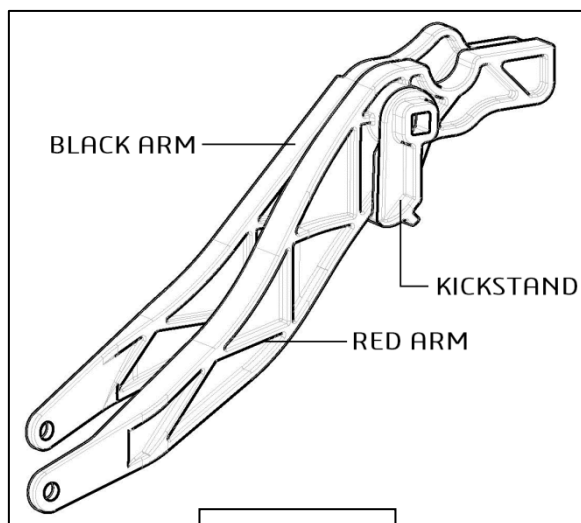

**FIGURE 4**

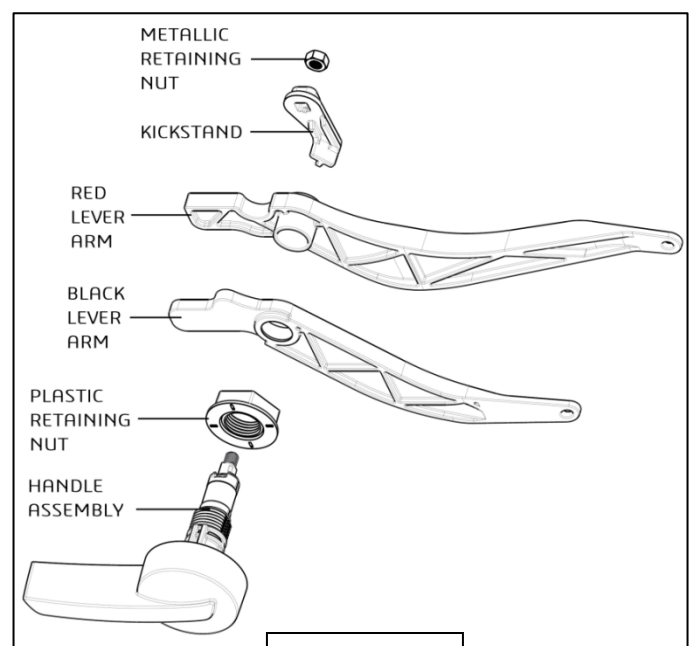

**FIGURE 3**