

## Flush Connections and Flanges

### Couplings and Gaskets

Item No.	Code No.	Part No.	Description
<b>F-2-A</b>			
1-3	<b>0306052</b>	F-2-A	3/4" CP Coupling Assembly
	<b>0306054</b>	F-2-A	3/4" RB Coupling Assembly
	<b>0306077</b>	F-2-A	1" CP Coupling Assembly
	<b>0306060</b>	F-2-A	1-1/4" CP Coupling Assembly
	<b>0306059</b>	F-2-A	1-1/4" RB Coupling Assembly
	<b>0306093</b>	F-2-A	1-1/2" CP Coupling Assembly
	<b>0306088</b>	F-2-A	1-1/2" RB Coupling Assembly
3-4	<b>0306092</b>	F-2-A	1-1/2" CP Coupling Assembly
	<b>0306087</b>	F-2-A	1-1/2" RB Coupling Assembly
1	<b>5306113</b>	F-5	3/4" SJ Gasket
	<b>5306115</b>	F-5	1" SJ Gasket
	<b>5322176</b>	VPF-5	1-1/4" SJ Gasket
	<b>5322001</b>	VPF-5	1-1/2" SJ Gasket
2	<b>5306055</b>	F-3	3/4" Friction Ring
	<b>5306056</b>	F-3	1" Friction Ring
	<b>5306057</b>	F-3	1-1/4" Friction Ring
	<b>5306058</b>	F-3	1-1/2" Friction Ring
3	*	F-2	3/4" CP Coupling
	*	F-2	3/4" RB Coupling
	*	F-2	1" CP Coupling
	*	F-2	1-1/4" CP Coupling
	*	F-2	1-1/4" RB Coupling
	<b>0306045PK</b>	F-2	1-1/2" CP Coupling
	*	F-2	1-1/2" RB Coupling
4	<b>5319086</b>	S-30	1-1/2" Gasket
5	<b>0319079</b>	S-21	1-1/2" Rigid Seat
3-5	<b>0306091</b>	F-2-A	1-1/2" with S-21 Seat

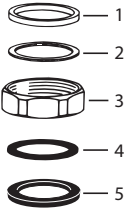

### NF-2-A

1	<b>0396264</b>	F-105	1-1/2" x 1-1/4" SJ Gasket
1-3	<b>0314011</b>	NF-2-A	1-1/2" x 1-1/4" SJ Reducing Coupling Assembly

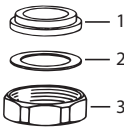

### Spud Coupling Assemblies

<b>F-5-A</b>			
1-4	<b>0306125</b>	F-5-A	3/4" CP Spud Coupling Assembly
	<b>0306132</b>	F-5-A	1" CP Spud Coupling Assembly
	<b>0306140</b>	F-5-A	1-1/4" CP Spud Coupling Assembly
	<b>0306146</b>	F-5-A	1-1/2" CP Spud Coupling Assembly
1-3	<b>0306516</b>	F-20-AW	3/4" Spud Coupling
	<b>0306524</b>	F-20-AU	1-1/4" Spud Coupling
	<b>0306526</b>	F-20-AT	1-1/2" Spud Coupling
2	<b>5306055</b>	F-3	3/4" Friction Ring
	<b>5306056</b>	F-3	1" Friction Ring
	<b>5306057</b>	F-3	1-1/4" Friction Ring
	<b>5306058</b>	F-3	1-1/2" Friction Ring
3	<b>5306113</b>	F-5	3/4" SJ Gasket
	<b>5306115</b>	F-5	1" SJ Gasket
	<b>5322176</b>	VPF-5	1-1/4" Gasket
	<b>5322001</b>	VPF-5	1-1/2" Gasket
4	<b>0306189</b>	F-7	3/4" Spud Flange
	<b>0306197</b>	F-7	1" Spud Flange
	<b>0306214</b>	F-7	1-1/4" Spud Flange
	<b>0306238</b>	F-7	1-1/2" Spud Flange

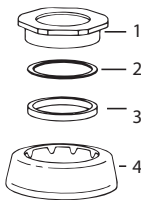

Note: 3-1/2" spud flange available in old style only.

The information contained in this document is subject to change without notice.

### Wall Flange For Tubing

Code No.	Part No.	Description
<b>F-7 (2-3/4" O.D. X 5/8" Deep)</b>		
<b>0306204</b>	F-7	1-1/4" Tube Flange
<b>0306237</b>	F-7	1-1/2" Tube Flange



### Supply Flange For Iron Pipe

<b>F-7 (2-3/4" O.D.)</b>		
<b>0306191</b>	F-7	3/4" IPS CP Supply Flange
<b>0306196</b>	F-7	1" IPS CP Supply Flange
<b>0306205</b>	F-7	1-1/4" IPS CP Supply Flange



### F-7 (2-3/4" O.D. Flat)

<b>0306167</b>	F-7	1/2" IPS CP Supply Flange
<b>0306188</b>	F-7	3/4" IPS CP Supply Flange
<b>0306201</b>	F-7	1" IPS CP Supply Flange
<b>0306209</b>	F-7	1-1/4" IPS CP Supply Flange



### F-45-A

<b>0396019</b>	F-45-A	3/4" Heavy Supply Flange with Set Screw for IPS
<b>0396020</b>	F-45-A	1" Heavy Supply Flange with Set Screw for IPS



For additional flanges, see 4.9.1

### Outlets

Item No.	Code No.	Part No.	Description
<b>F-1 (Flanged)</b>			
1	<b>5319086</b>	S-30	Gasket
2	<b>0306007</b>	F-1	1-1/2" x 1-1/4" x 6" CP Flanged Outlet
	<b>0306009</b>	F-1	1-1/2" x 1-1/4" x 8" CP Flanged Outlet
	<b>0306012</b>	F-1	1-1/2" x 1-1/4" x 10" CP Flanged Outlet
	<b>0306013</b>	F-1	1-1/2" x 1-1/4" x 12" CP Flanged Outlet
	<b>0306031</b>	F-1	1-1/2" x 6" CP Flanged Outlet
	<b>0306034</b>	F-1	1-1/2" x 8" CP Flanged Outlet
	<b>0306039</b>	F-1	1-1/2" x 10" CP Flanged Outlet
	<b>0306044</b>	F-1	1-1/2" x 12" CP Flanged Outlet

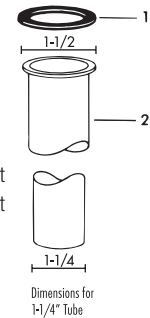

### F-22

1	<b>5319086</b>	S-30	Gasket
2	<b>0206159</b>	F-22	1/2" IPS RB Female Outlet
	<b>0206160</b>	F-22	3/4" IPS RB Female Outlet
	<b>0306569</b>	F-22	1" IPS RB Female Outlet

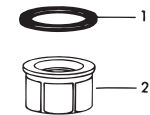

### F-22-A

1-2	<b>0306574</b>	F-22-A	1-1/4" IPS RB Union Outlet Assembly
	<b>0306575</b>	F-22-A	1-1/4" IPS CP Union Outlet Assembly
1	<b>5319086</b>	S-30	Gasket

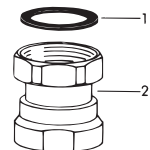

### F-29-A

1	<b>5319086</b>	S-30	Gasket
2	<b>0306767</b>	F-29-A	3/4" x 6" CP Outlet
	<b>0306769</b>	F-29-A	3/4" x 7-1/2" RB Outlet
	<b>0306773</b>	F-29-A	3/4" x 8-1/2" CP Outlet
	<b>0306791</b>	F-29-A	3/4" x 10-1/2" RB Outlet

