

# BECAUSE *JUST ADD WATER* IS PRETTY MUCH THE INSTRUCTIONS FOR A WONDERFUL LIFE.

## Thank you for buying an American Standard faucet.

We're so grateful you did, and you will be too. Because faucets don't just bring us water—they're called upon to clean up brownie pans, luxuriated under by sleepy not-morning-people, and spit on by teeth-brushing kids. How do we know? Just like you, we've lived with that same beautiful chaos called life for almost 150 years. We believe that while every home should appreciate in value, we never forget the sentimental value that grows from enjoying life in the heart of home—your kitchen and bath. That's why we love your stories and ideas; they help us innovate with products that make your life easier.

Or, visit **[americanstandard-us.com/bathroom/sink-faucets](https://americanstandard-us.com/bathroom/sink-faucets)**  
to watch video, view/download installation manuals  
or learn more about your product.

## Have a question or need help on install?

For questions or help on installation call us at **855-815-0004**.

*American Standard*

# OWNERS MANUAL

## Touchless Soap Dispenser

7770 / 777B



### INSIDE THE BOX

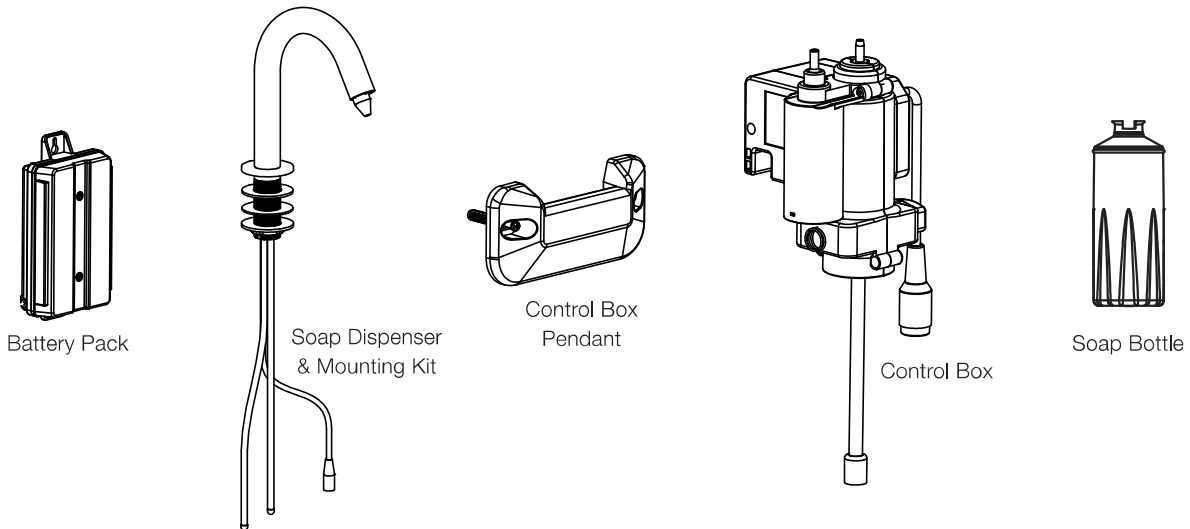

### RECOMMENDED TOOLS

Installation steps will indicate which tools should be used with associated letter

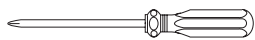

Phillips  
Screwdriver

**A**

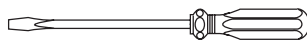

Flat Blade  
Screwdriver

**B**



Channel  
Locks

**C**



Adjustable  
Wrench

**D**

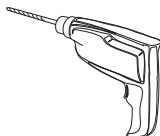

Drill

**E**



Level

**F**

Image shown may vary from product purchased.

*American Standard*

# INSTALLATION INSTRUCTIONS

1

## INSTALL SPOUT

- Insert the SPOUT and HOSES (1) through the deck hole.  
**NOTE:** Deck thickness - 8 mm to 50 mm  
**NOTE:** Deck hole diameter - 25 mm to 28 mm
- Install RUBBER WASHER (2) and METAL WASHER (3).
- Thread the MOUNTING NUT (4) on to the shank and tighten to secure the faucet.

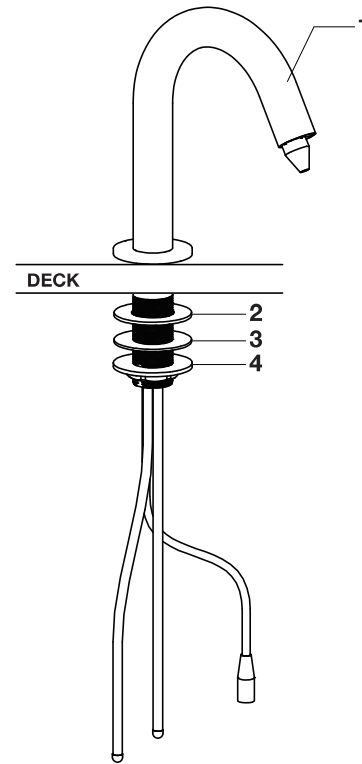

C

2

## INSTALL CONTROL BOX PENDANT

- Drill holes in the wall under the sink 94 mm apart.  
**NOTE:** Recommended height is 350 mm above the floor to avoid interference with the soap bottle and 300 mm below the counter top to provide overhead clearance for installing the control box.
- **OPTIONAL:** Use DRY WALL ANCHORS (2) if applicable.
- Thread the SCREWS (1) through the CONTROL BOX PENDANT (3) and in to the wall to secure it.

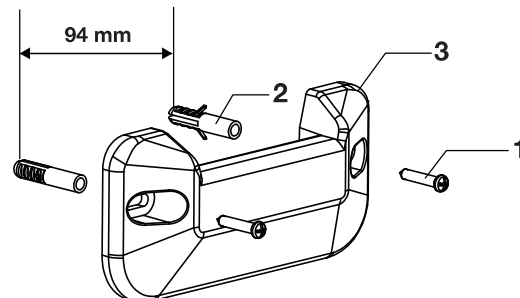

A

E

F

*American Standard*

### 3

#### INSTALL CONTROL BOX

- Insert the CONTROL BOX (1) in to the CONTROL BOX PENDANT (2).

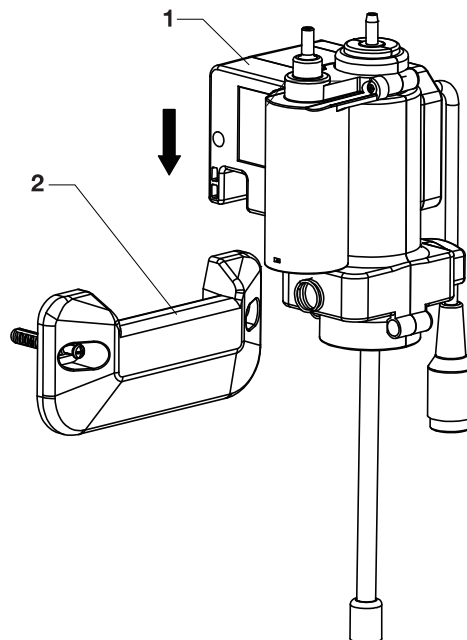

### 4

#### INSTALL BATTERY PACK



**For DC powered Soap Dispensers only.**

- Unscrew the SCREWS (1) on the battery pack.
- Insert four BATTERIES (2) and reinstall the battery pack cover.
- Drill holes in the wall under the sink 162 mm apart.  
**NOTE:** the battery pack can be used as a hole template.
- **NOTE:** Recommended height is 350 mm above the floor.
- **OPTIONAL:** Use DRY WALL ANCHORS (3) if applicable.
- Thread the SCREWS (1) through the battery pack and in to the wall to secure it.

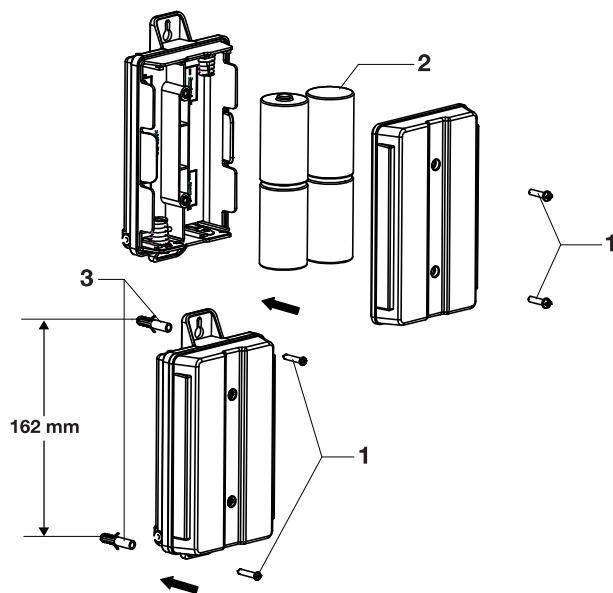

**A E**

## 5A

### CONNECT WIRING



For DC powered Soap Dispensers only.

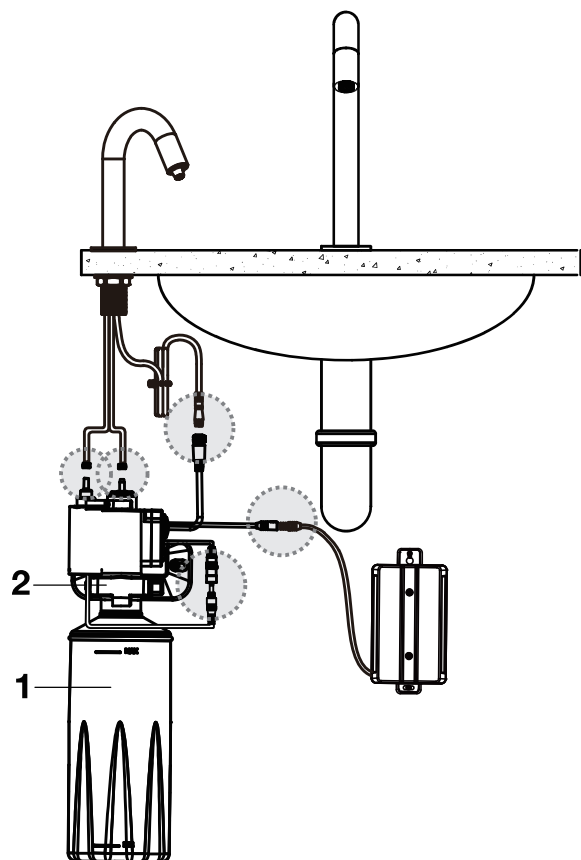

- Connect the wiring as shown in the image.
- Install the SOAP BOTTLE (1) on to the CONTROL BOX (2).

## 5B

### CONNECT WIRING



For AC powered Soap Dispensers only.

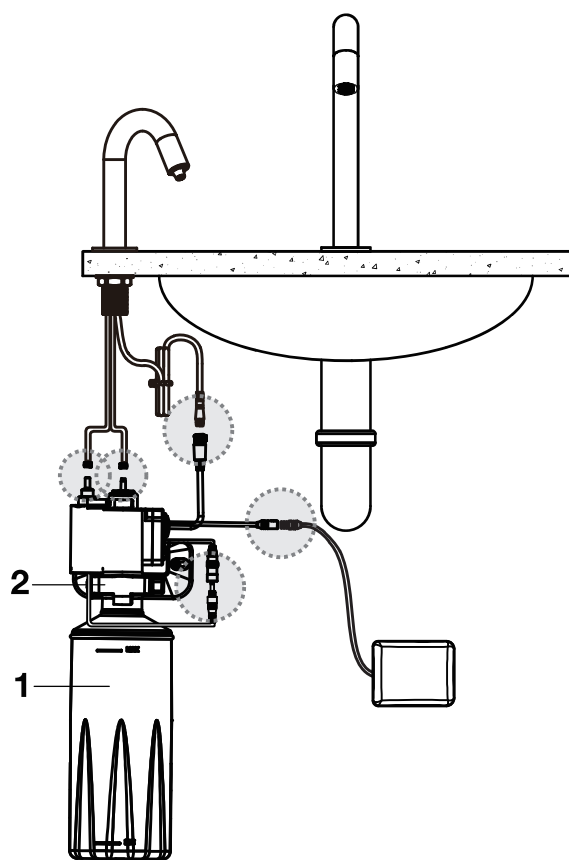

- Connect the wiring as shown in the image.
- Install the SOAP BOTTLE (1) on to the CONTROL BOX (2).

- Fill the soap bottle with liquid soap.
- Press and hold the dispenser button on the control box. Release when soap begins to dispense from the spout.
- Activate the soap dispenser by placing hand in front of the spout tip.

**NOTE:** It has four soap dispense volume adjustment:

1. Low
2. Medium
3. High
4. Extra High

Low Volume

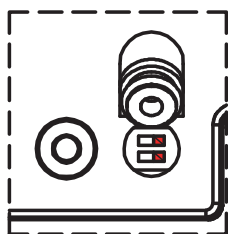

Medium Volume

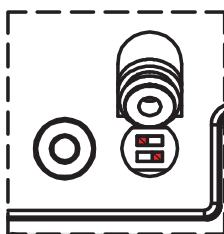

High Volume

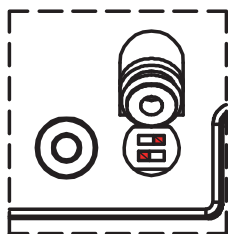

Extra High Volume

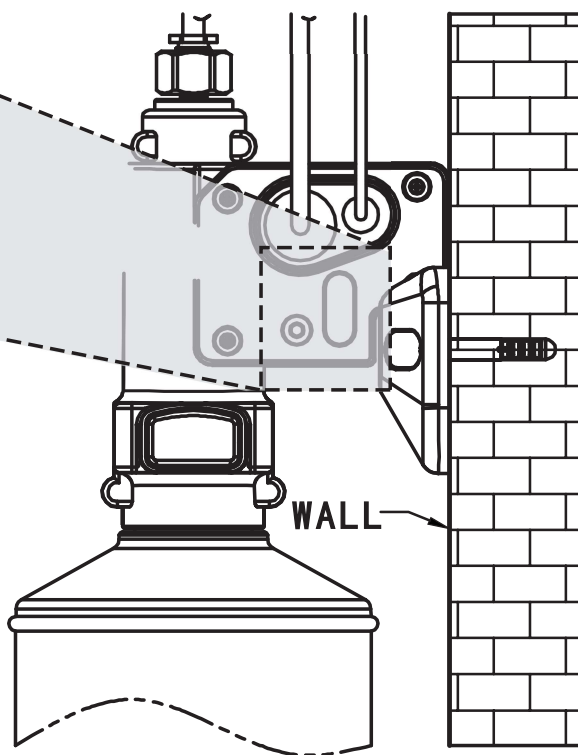
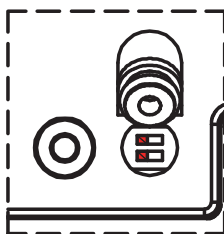

**Sensor Adjustment:**

- Move a magnet close to the sensor at the top of the faucet. An LED light will flash continuously during the adjustment. When the light stops flashing, the sensor is now adjusted to its surroundings and should operate normally when a hand/object is moved within the sensor range.

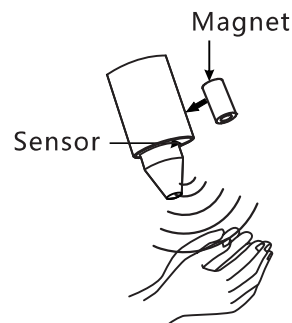
**Nozzle Cleaning:**

- After a week of not being used there is a risk of soap build up in the nozzle. Follow these steps to clean the nozzle after being idle:

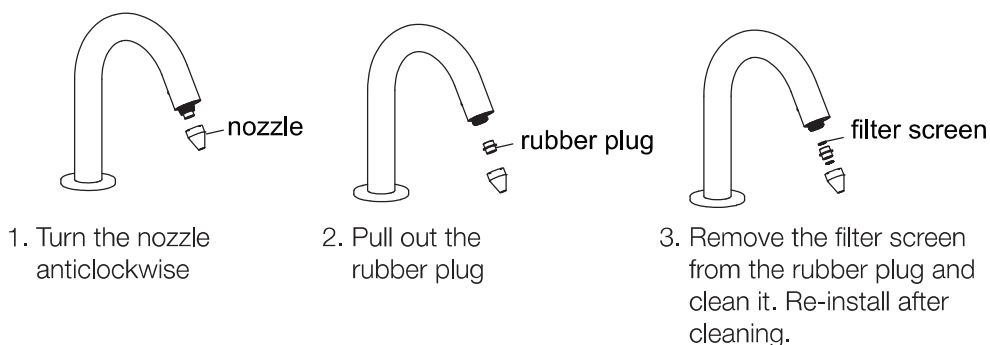
**Pump Maintenance:**

- The soap pump may not be able to pump any liquid due to the machine being idle or the soap being completely depleted before replacing the bottle.

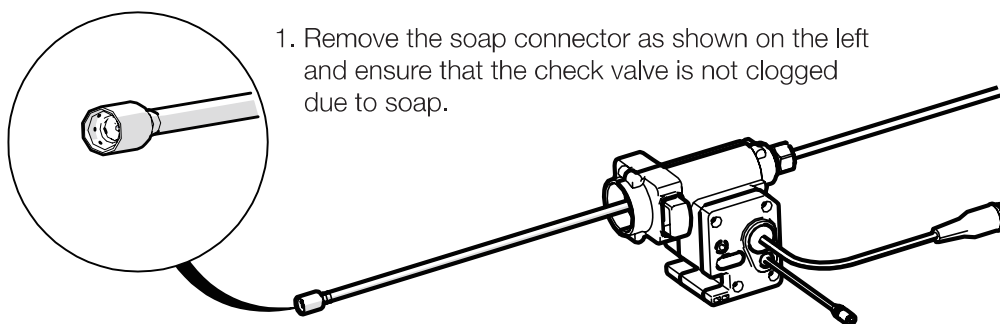

2. Place the controller leveled, connect the power supply and press the start button on the controller. After starting the motor to fill the gear pump with liquid, the controller can be installed back into the soap bottle for normal use.

**Replacing Batteries:**

**For DC powered Soap Dispensers only.**

- Replace the batteries when a light in the sensor window blinks.
- Unscrew the SCREWS (1) on the battery pack.
- Insert four BATTERIES (2) and reinstall the battery pack cover.

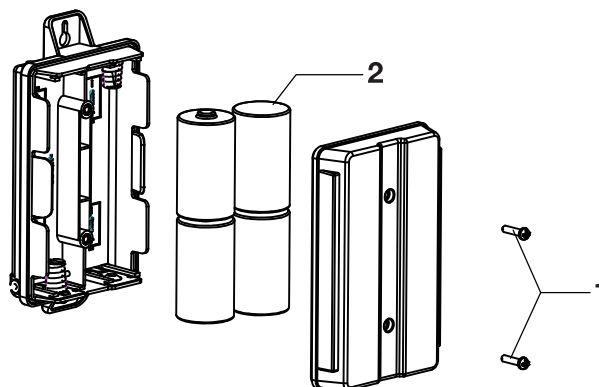

**A**

**Refilling Soap:**

- Refill the soap bottle when the soap reaches 20 mm from the bottom of the bottle. Do not let it completely deplete.
- Press the BUTTON (1) to unlock the soap bottle.

**Note:** Hold the soap bottle when unlocking it as the soap bottle detaches quickly.

- Clean the soap bottle periodically with water to prevent buildup.
- Do not use abrasive soaps with particles as this can lead to clogs.
- Push the refilled soap bottle back in to the locking mechanism.

**Recommended Soap:**

- Clean Revolution® Foaming Hand Soap
- Foam Soap with 1-20 cps Viscosity Range

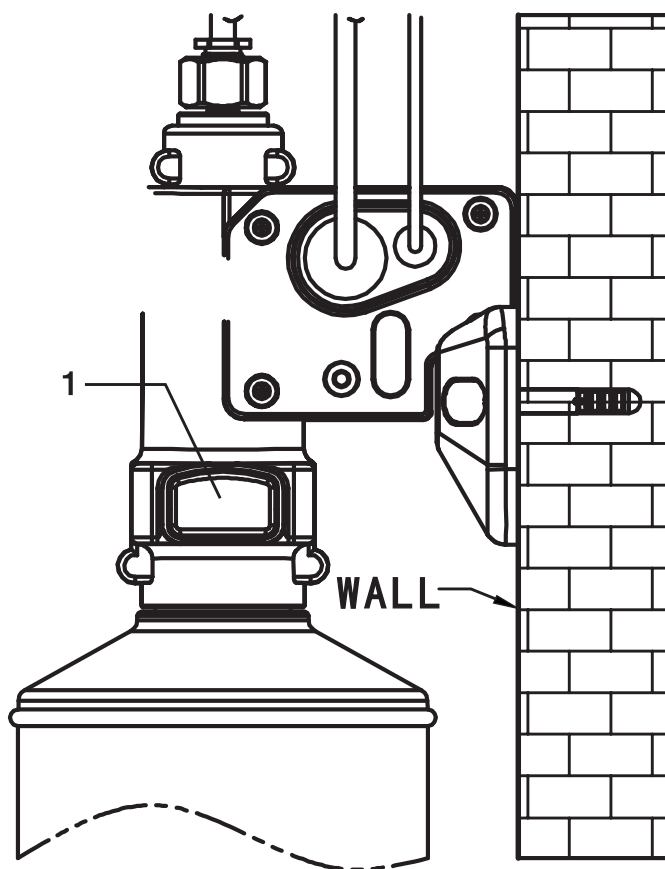



## Troubleshooting

SYMPTOMS	PROBABLE CAUSE	RECOMMENDED ACTION
An LED light flashes at the base of the soap dispenser twice every 2-3 seconds.	Low battery is out of power (lower than 3.9 volts)	Replace the batteries and prime the soap dispenser
No soap dispenses.	The sensor lens is dirty	Wipe the sensor lens with a clean, dry, soft cloth
	The sensor cable is disconnected	Reconnect the sensor cable
	The tube (soap and air) is disconnected	Reconnect the tube to the control box
	No power supply or wrong connection	Check the power supply connection
	The soap pump is not primed after refilling	Prime the pump
	The dispensing tube/check valve is blocked	Clean the dispensing tube/check valve with warm water
Insufficient amount of soap dispensed.	The nozzle is clogged	Remove the nozzle and foaming assembly. Clean with warm water
	The check valve is clogged	Remove the check valve from dispensing tube. Clean with warm water
	The soap pump is not working correctly	Order and install a new soap pump
Only air bubbles are dispensing.	The soap pump outlet is clogged	Remove the soap pump tubing
	The soap pump is leaking	Order and install a new soap pump
No foam is dispensing. Only liquid soap is dispensing.	The air pump is disconnected	Check the air pump connection and reconnect the tube to the control box
	The air pump/tube is clogged	Remove the air pump tubing. Clean the air pump outlet with warm water
	The air pump is not working	Order and install a new air pump

# WARRANTY

## FAUCET LIMITED LIFETIME FUNCTION AND FINISH WARRANTY

FOR RESIDENTIAL INSTALLATIONS: AS America, Inc. ("American Standard®") warrants this product to be free from defects in materials or workmanship for as long as the original consumer purchaser owns this product. Proof of purchase (original sales receipt) from the original consumer purchaser must be made available to American Standard for all warranty claims. This warranty is non-transferable. It does not apply in the event of product damage due to the use of other than genuine American Standard replacement parts, installation error, abuse, misuse or improper care and maintenance (whether performed by a plumber, contractor, service provider or member of the purchaser's household). The warranty excludes damage due to aggressive air or water conditions, or harsh or abrasive cleaners and/or materials.

FOR COMMERCIAL INSTALLATIONS: For all industrial, commercial and business usage the warranty period is five years, from date of purchase and except for duration, all other aforementioned warranty terms apply. For both Residential and Commercial warranties, batteries are not included in the warranty.

FOR ELECTRONIC FAUCETS, VALVES AND CONTROLS: American Standard warrants its electronic faucets, valves and controls to be free from manufacturing defects in material and workmanship under normal use for five (5) years from the date of purchase by or for the original consumer owner. American Standard will provide free of charge, at its sole option, replacement part(s) or product (or if no longer available, a comparable product) to replace those which have proven defective in materials or workmanship.

This warranty does not cover labor charges incurred and/or damage sustained in installation, repair or replacement, nor incidental or consequential damages. This warranty is effective for all faucets sold after March 1, 2018.

THIS WARRANTY IS EXCLUSIVELY IN LIEU OF ALL OTHER WARRANTIES, INCLUDING ANY IMPLIED WARRANTIES OF MERCHANTABILITY OR FITNESS FOR A PARTICULAR PURPOSE.

This warranty gives the original consumer purchaser of an American Standard faucet specific legal rights which may vary from state to state or from province to province. In some states or provinces the exclusion or limitation of incidental or consequential damages is not allowed, so those exclusions may not apply to you.

### UNITED STATES

American Standard Brands  
1 Centennial Ave  
Piscataway, New Jersey 08854  
Attention: Director of Customer Care  
For residents of the United States,  
warrantyinformation may also be obtained  
by calling the following toll free number:  
(800) 442-1902  
[www.americanstandard.com](http://www.americanstandard.com)

### CANADA

LIXIL Canada, Inc.  
5900 Avebury Rd.  
Mississauga, Ontario  
Canada L5R 3M3  
Toll Free: (800) 387-0369  
[www.americanstandard.ca](http://www.americanstandard.ca)

### MEXICO

American Standard B&K Mexico  
S. de R.L. de C.V.  
Via Morelos #330  
Col. Santa Clara  
Ecatepec 55540 Edo. Mexico  
Toll Free: 01-800-839-1200  
[www.americanstandard.com.mx](http://www.americanstandard.com.mx)

### PLEASE COMPLETE AMERICAN STANDARD WARRANTY REGISTRATION PROCESS AND SAVE THIS WARRANTY INFORMATION

**IMPORTANT:** Registration of the faucet must be completed for this warranty to become effective. Your registration will make it easier to contact you in the event of a product recall.\*

**INSTRUCTIONS:** Register your faucet at [www.americanstandard.com](http://www.americanstandard.com). Please save your proof of purchase (sale receipt).

If you need assistance or do not have access to our website, please contact American Standard Customer Care at: (800) 442-1902. An American Standard representative will assist in completing the warranty registration.

\*In California, your warranty rights remain intact even if you do not complete the registration process.

**THIS WARRANTY IS NOT TRANSFERABLE FROM ORIGINAL CONSUMER PURCHASER.**

*American Standard*

# TELL US WHAT YOU THINK!



Please leave us a product review or story at **[americanstandard.com/reviews](https://americanstandard.com/reviews)**



## Happy I purchased this faucet

08/22/2019 00:04:41 CDT American Standard [Kitchen Faucets](#) [Xavier SelectFlo Pull-Down Kitchen Faucet](#)

I enjoy the SelectFlo pull-down kitchen faucet with three spray patterns. It's a great fit, finish and overall quality has been excellent.

Register your warranty and sign up for an idea-filled newsletter at **[americanstandard.com/warranty](https://americanstandard.com/warranty)**.

Find installation videos at **[youtube.com/americanstandard](https://youtube.com/americanstandard)**.



## SHARE YOUR NEW PRODUCT!

Tag us **@american\_standard** on Instagram and show us how your new product looks.

## ≡ WANT MORE INFO?

For questions or help call us at **855-815-0004**, or visit **[americanstandard.com](https://americanstandard.com)**