

Overview

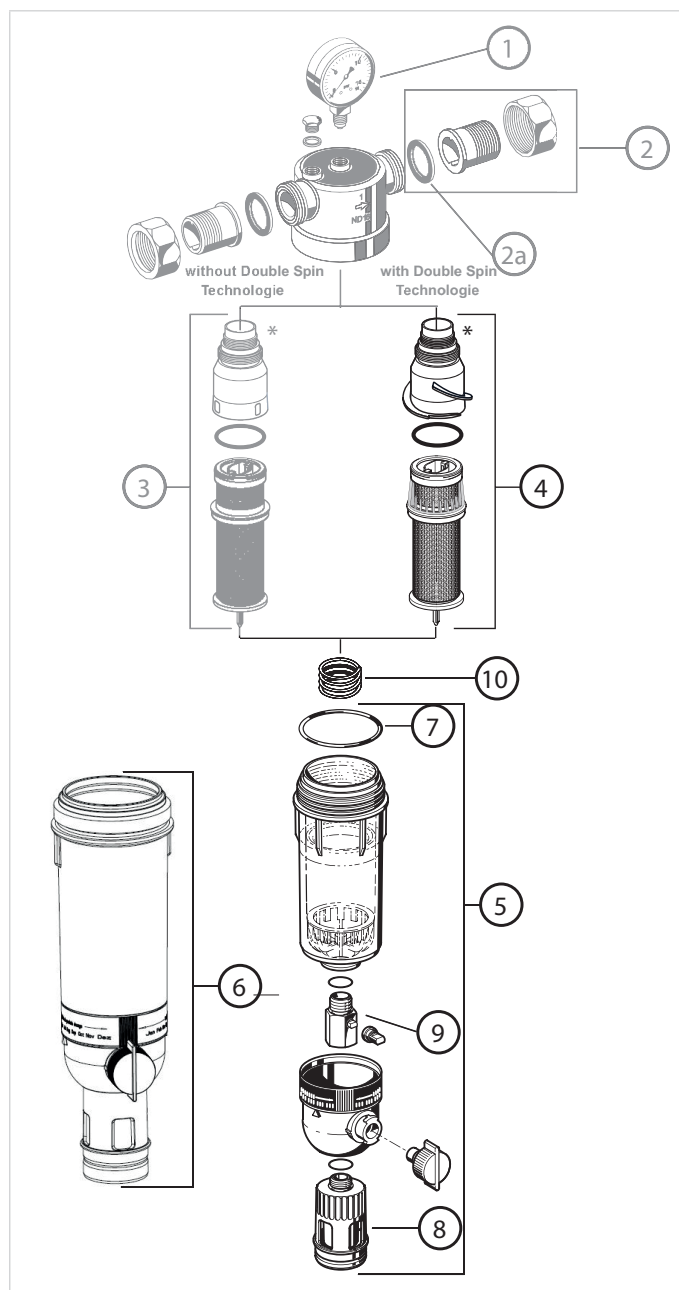

Description

Dimension

Part No.

4 Filter insert complete*, for filters with Double Spin Technologie

Filter mesh size: 100 µm	1/2" - 3/4"	AF11DS-1/2A
Filter mesh size: 20 µm	1/2" - 3/4"	AF11DS-1/2B
Filter mesh size: 50 µm	1/2" - 3/4"	AF11DS-1/2C
Filter mesh size: 200 µm	1/2" - 3/4"	AF11DS-1/2D
Filter mesh size: 300 µm	1/2" - 3/4"	AF11DS-1/2E
Filter mesh size: 500 µm	1/2" - 3/4"	AF11DS-1/2F
Filter mesh size: 100 µm	1" - 1 1/4"	AF11DS-1A
Filter mesh size: 20 µm	1" - 1 1/4"	AF11DS-1B
Filter mesh size: 50 µm	1" - 1 1/4"	AF11DS-1C
Filter mesh size: 200 µm	1" - 1 1/4"	AF11DS-1D
Filter mesh size: 300 µm	1" - 1 1/4"	AF11DS-1E
Filter mesh size: 500 µm	1" - 1 1/4"	AF11DS-1F

5 Clear filter bowl

1/2" - 1 1/4"	KF11S-1A
1 1/2" - 2"	KF11S-11/2A

6 Red bronze filter bowl

1/2" - 1 1/4"	FT09RS-1A
1 1/2" - 2"	FT09RS-11/2A

7 O-ring set (10 pcs.)

1/2" + 1 1/4"	0900747
1 1/2" + 2"	0900748

8 Drain connector

1/2" - 2"	AA76-1/2A
-----------	-----------

9 Ball valve complete

1/2" - 2"	KH11S-1A
-----------	----------

10 Spring

1/2" - 1 1/4"	2074900
1 1/2" - 2"	2159400

*The filter guide (either with double spin or without double spin feature) is included in the packaging of the replacement filter inserts (AF11DS and AF11S) only for the sizes 1/2" up to 1 1/4"!

Note: 1 - 3 see on page 7