

**Body Spray (Round)**  
**Ducha Lateral (Redondo)**  
**Douche Latérale (Tour)**  
**Duche Lateral (Redondo)**

**Comfort Wave® & Intense Wave®**

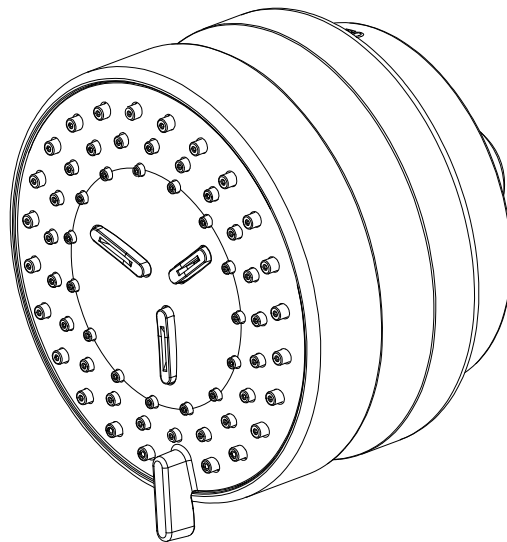

**TBW07017U**

**Warranty Registration and Inquiry**

For product warranty registration, TOTO U.S.A. Inc. recommends online warranty registration. Please visit our web site <http://www.totousa.com>. If you have questions regarding warranty policy or coverage, please contact TOTO U.S.A. Inc., Customer Service Department, 1155 Southern Road, Morrow, GA 30260 (888) 295-8134 or (678) 466-1300 when calling from outside of U.S.A.

## TABLE OF CONTENTS

Thanks for Choosing TOTO! .....	2
Care & Cleaning .....	2
Before Installation.....	2
Common Tools Needed .....	2
Warnings.....	2
Included Parts .....	3
Installation Procedure .....	3-5
Warranty .....	6
Rough-In Dimensions .....	23

## THANKS FOR CHOOSING TOTO!

The mission of TOTO is to provide the world with healthy, hygienic and more comfortable lifestyles. We design every product with the balance of form and function as a guiding principle. Congratulations on your choice.

## CARE & CLEANING

Your new bodyspray is designed for years of trouble-free performance. Keep it looking new by cleaning it periodically with mild soap, rinsing thoroughly with warm water and drying with a clean, soft cloth. Do not use abrasive cleaners, steel wool or harsh chemicals, as these will dull the finish. Failure to follow these instructions may void your warranty.

## BEFORE INSTALLATION

- Observe all local plumbing codes.
- Make sure the water supply is shut off.
- Read these instructions carefully to ensure proper installation.
- TOTO reserves the right to update the product design without notice.

## COMMON TOOLS NEEDED

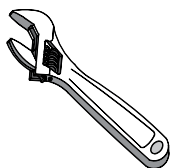

Adjustable  
Wrench

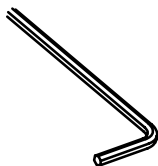

Hex Wrench  
12mm



Hex Wrench  
2.5mm



Pipe Tape

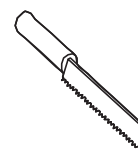

Hacksaw

## WARNINGS

For safe operation of the valve and sprays, please observe the following:

- Recommended Operating pressure:
  - Minimum Pressure.....20 psi (0.14 MPa), dynamic
  - Maximum Pressure.....80 psi (0.55 MPa), static
- Do not solder the connections directly to the valve as damage to the internal components may occur.
- Do not use the product at an ambient temperature below 32°F (0°C).

## INCLUDED PARTS

Check to make sure that all these parts were included in your packaging:

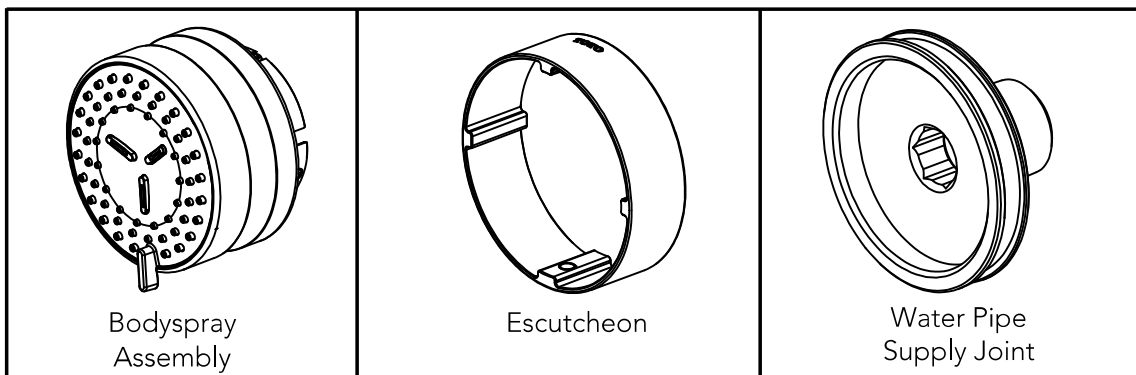

ENGLISH

## INSTALLATION PROCEDURE

1. Cleaning the water supply pipe  
Before installation, be sure to flush away any debris or foreign materials from the water supply pipe.
2. Installation of the Body Spray

### TBW07017U\* Series

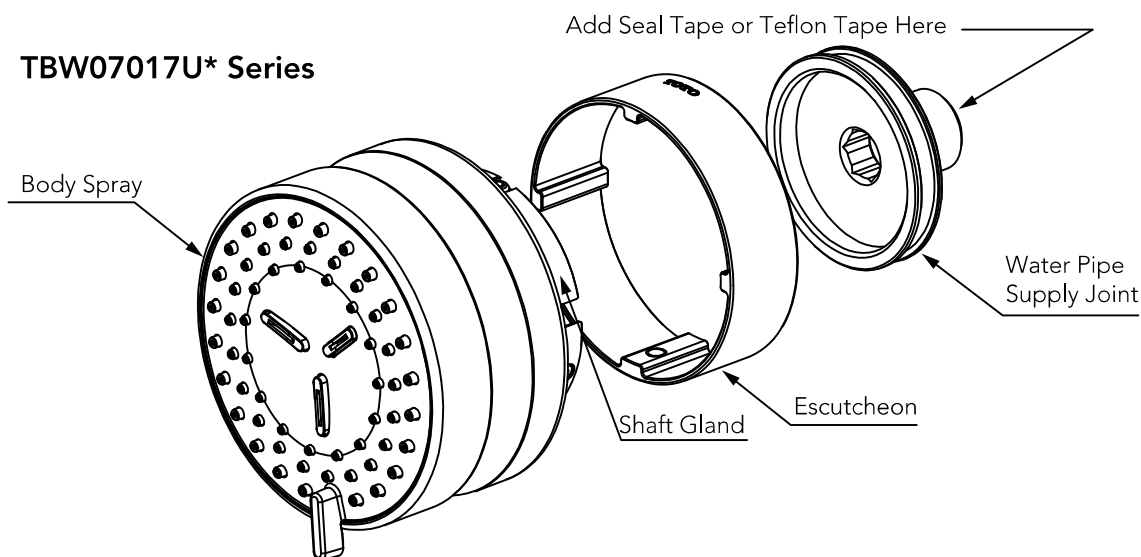

### Installation of Supply Line Elbow

- (1) End face of the built-in supply line elbow joint is 0~10mm away from the finished wall surface.
- (2) Please ensure the effective thread depth in the supply line elbow is at least 13.5mm (17/32"), otherwise the water pipe supply joint cannot be installed properly.  
(As shown in Figure 1)

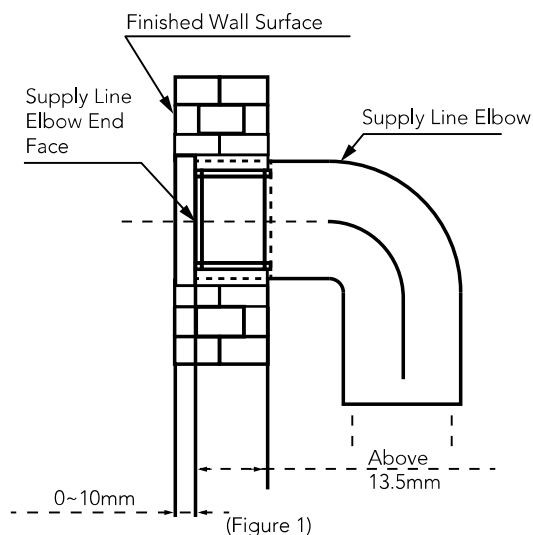

**ENGLISH**

Figure 2 is a technical diagram illustrating the installation of a water pipe supply joint. The diagram shows a horizontal pipe connected to a wall. A hex wrench H12 is used to adjust the joint. The wall surface is labeled "Wall Surface". The joint is labeled "Water Pipe Supply Joint". The pipe is labeled "1/2\" NPT". The elbow is labeled "Supply Line Elbow". The diagram is labeled "(Figure 2)".

- ## Installation of the Escutcheon

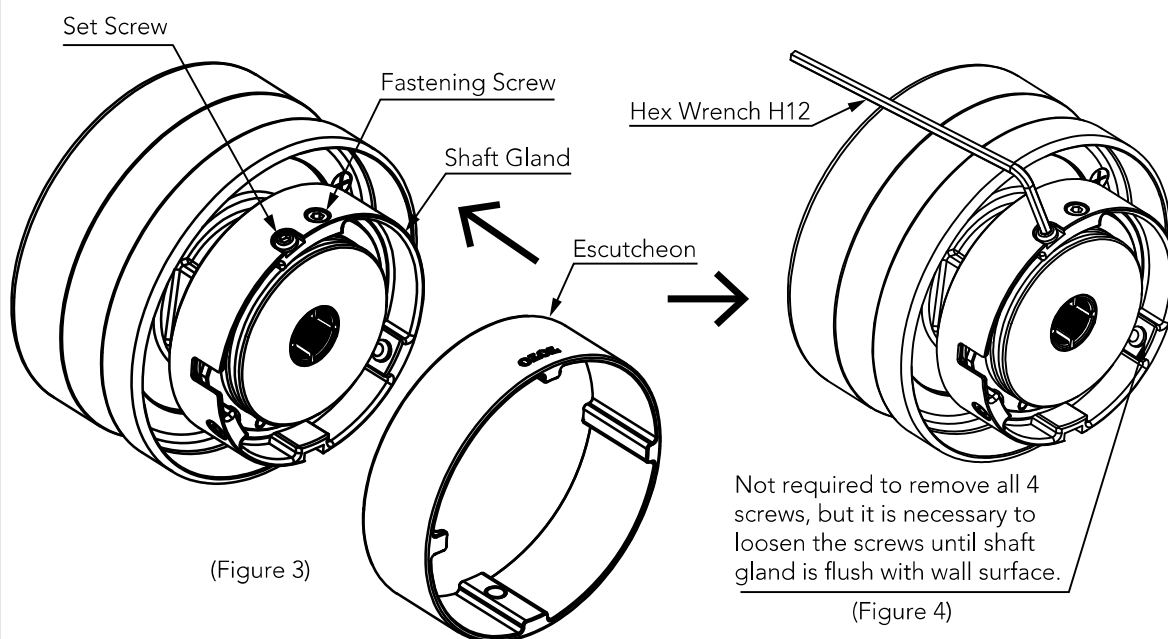

- 4

## INSTALLATION PROCEDURE

### Body Spray Installation

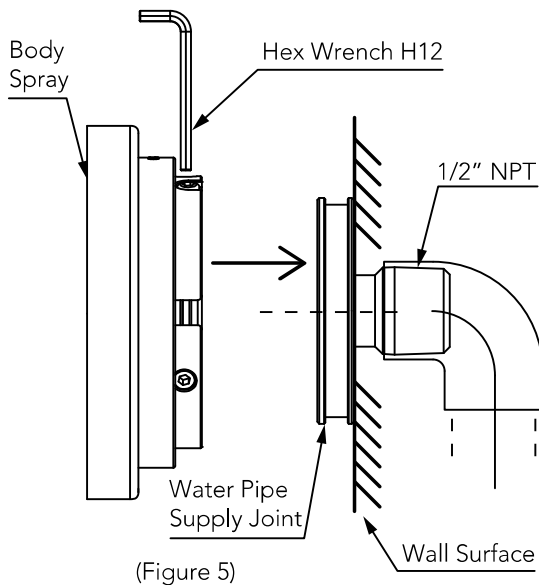

(Figure 5)

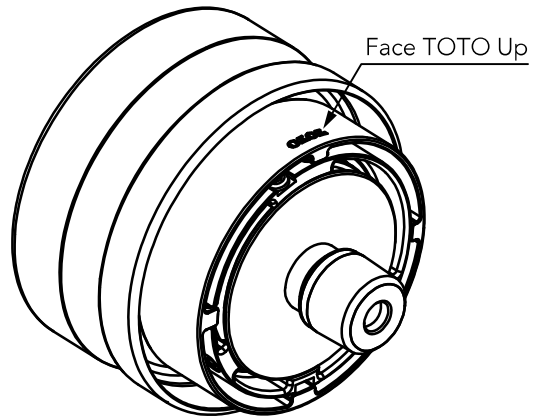

(Figure 6)

- (5) Put the shower body spray in the water pipe supply joint, and tighten the 4 screws (3 fastening screws and 1 set screw) on the shaft gland; and face TOTO up while installing (as shown in Figure 5 and Figure 6)

### Fastening of the Escutcheon

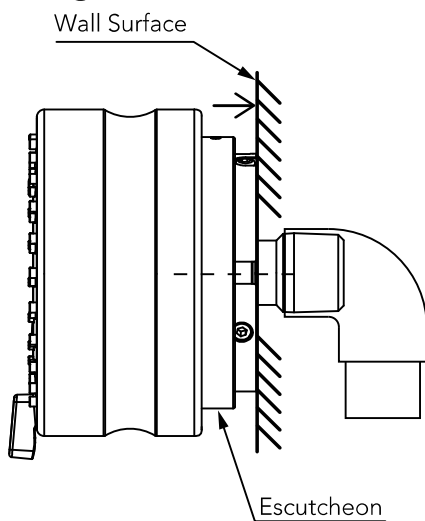

(Figure 7)

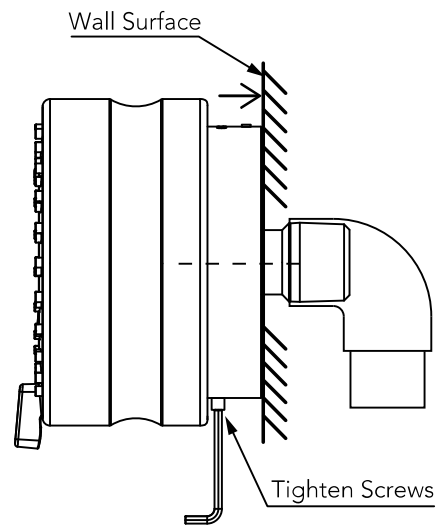

(Figure 8)

- (6) Place the escutcheon close to the finished wall surface, and use the hex wrench to tighten the screw located at the bottom of the escutcheon (as shown in Figure 8)